

LONDON BOROUGH OF CAMDEN

HOLMES ROAD AREA: EXPERIMENTAL ON-STREET CHANGES RELATING TO THE PROVISION OF MOTOR VEHICLE RESTRICTIONS NEAR SCHOOLS AND ASSOCIATED “DOUBLE YELLOW LINES”

The Camden (Prescribed Routes) (Cathcart Street, Holmes Road and Willes Road) (No. 1) Experimental Traffic Order 2024

The Camden (Parking Places) (CA-L) (Cathcart Street and Willes Road) (No. 1) Experimental Traffic Order 2024

The Camden (Waiting Restrictions) (Cathcart Street and Willes Road) (No. 1) Experimental Traffic Order 2024

Notice is hereby given that the Council of the London Borough of Camden on 28 November 2024 made the above Orders under sections 9 and 124 of and Part IV of Schedule 9 to the Road Traffic Regulation Act 1984, as amended. The Orders will come into force on 13 January 2025.

The general nature and effect of the Orders will be on an experimental basis:-

- (a) in **Holmes Road**, to provide a ‘no motor vehicles’ restriction applying ‘at any time’ to westbound vehicles, 4 metres west of the western kerb-line of Raglan Street;
- (b) in **Cathcart Street**, to:
 - (i) provide a no motor vehicles restriction applying to north-westbound vehicles at the boundary of Nos. 7 and 8 Cathcart Street between 8am and 9am and between 3.30pm and 4.30pm on Mondays to Fridays inclusive;
 - (ii) provide a no motor vehicles restriction applying to south-eastbound vehicles at its junction with Holmes Road applying ‘at any time’;
 - (iii) remove 10.9 metres of CA-L permit holders parking space and replace it with ‘at any time’ waiting restrictions on the south-west side, outside Nos. 6 to 8 Cathcart Street to allow for vehicle turning;
 - (iv) remove 5.5 metres of CA-L permit holders parking space and provide ‘at any time’ waiting restrictions on the north-east side, adjacent to No. 87 Holmes Road to improve sightlines;
- (c) in **Willes Road**, to:
 - (i) provide a no motor vehicles restriction applying to south-eastbound vehicles at a point 4 metres south-east of the south-eastern kerb-line of Holmes Road between 8am and 9am and between 3.30pm and 4.30pm on Mondays to Fridays inclusive;
 - (ii) provide a no entry except pedal cycles applying in both directions at its junction with Inkerman Road applying ‘at any time’;
 - (iii) remove 11 metres of CA-L permit holders parking space and provide 11.6 metres of ‘at any time’ waiting restrictions on the south-west side, opposite

Nos. 38 and 40 Willes Road to allow for vehicle turning and remove 11 metres of CA-L permit holders parking space and provide 10.9 metres of 'at any time' waiting restrictions on the north-east side, outside Nos. 38 and 40 Willes Road, to allow for vehicle turning.

Exemption to the timed no motor vehicle restrictions would be provided for 'Plus Bus door to door' and 'Dial-a-ride' buses. Exemption to all the no motor vehicle restrictions would be provided for emergency services, and such other vehicles as may be authorised by the Council.

Plans of the above locations, a copy of the made Orders, the Notice of Making and the Council's Statement of Reasons for making the Orders may be inspected at <http://www.camden.gov.uk/recently-advertised-proposals/> or by contacting traffic.orders@camden.gov.uk or may be inspected in person by appointment only at 5 Pancras Square, London, N1C 4AG, between the hours of 9am and 5pm on Mondays to Fridays excluding bank and public holidays (please contact traffic.orders@camden.gov.uk to arrange an appointment). The Orders provide that in pursuance of section 10(2) of the Act, the specified officer may, if it appears essential in the interests of the expeditious, convenient and safe movement of traffic on the highway or for preserving or improving the amenities of the area through which any road affected by the Orders run, modify or suspend the Orders or any of their provisions.

The Orders are to be on an experimental basis for a maximum period of 18 months and the Council will be considering in due course whether the provisions of the Orders should be continued in force indefinitely by means of permanent Orders made under Sections 6, 45, 46 49, 124 and Part IV of Schedule 9 of the Act of 1984. Any person may object to the making of the permanent Orders for the purpose of such indefinite continuation within a period of six months beginning with the day on which the above-mentioned Orders came into operation or, if any of the Orders are varied by any other Order, beginning with the day on which the latest variation or modification came into operation. Any person wishing to object or make representations in respect of the proposed Orders, should send comments in writing, quoting reference 'TMO2425-0025' and giving reasons for any objection to traffic.orders@camden.gov.uk or by post to 'FREEPOST LBC TRANSPORT STRATEGY' by 14 July 2025.

Peter Mardell

Head of Parking Operations

28 November 2025

LONDON BOROUGH OF CAMDEN

On-street changes relating to the provision of motor vehicle restrictions near schools and associated “double yellow lines”

The Camden (Prescribed Routes) (Cathcart Street, Holmes Road and Willes Road) (No. 1) Experimental Traffic Order 2024

The Camden (Parking Places) (CA-L) (Cathcart Street and Willes Road) (No. 1) Experimental Traffic Order 2024

The Camden (Waiting Restrictions) (Cathcart Street and Willes Road) (No. 1) Experimental Traffic Order 2024

STATEMENT OF REASONS

Streets in the area around Holmes Road between Prince of Wales Road and Kentish Town Road are primarily residential in nature and home to two schools.

Large volumes of traffic use Holmes Road, as well as other streets in the area, as a cut-through to avoid the traffic lights at the junction of Prince of Wales Road and Kentish Town Road.

In order to provide children (and parents) with the opportunity to travel to and from school in a safer environment, a trial Healthy School Street (timed road closure) was introduced on Holmes Road outside St Patrick’s Primary School in May 2022, in addition to an ‘at all times’ motor vehicle restriction on Raglan Street.

To improve access to properties on Raglan Street, the one-way southbound designation of Anglers Lane between Alma Street and Willes Road was removed.

In response to feedback received and monitoring undertaken during the trial period, these trial elements were made permanent, and several new schemes/measures were proposed, consulted upon and approved via a decision report published in November 2023.

Experimental Traffic Management Orders are required to facilitate the following traffic management proposals, as this will enable these elements of the scheme to be delivered while providing additional opportunities for monitoring and the collection of feedback from local stakeholders:

- (a) A westbound ‘at all times’ motor vehicle restriction on Holmes Road to reduce motor vehicle traffic volumes in the area.
- (b) An ‘at all times’ motor vehicle restriction on Willes Road located to the north of the junction with Inkerman Road to stop Willes Road from being used as a cut-through for motor vehicles travelling from Prince of Wales Road to Kentish Town Road. Double yellow lines will replace certain lengths of permit holders parking space near to the road closure to allow space for vehicles to turn around.
- (c) A Healthy School Street (timed motor vehicle restriction) on Willes Road between Inkerman Road and Holmes Road (operating Monday - Friday, 8am - 9am and 3:30pm-4:30pm) to discourage car trips, particularly amongst parents

and carers and provide a safe and inviting space for more walking, cycling and scooting outside Collège Français Bilingue de Londres.

- (d) a southbound motor vehicle restriction on Cathcart Street, directly to the south of the junction with Holmes Road to prevent southbound vehicles, which may otherwise travel down Willes Road, from being displaced onto Cathcart Street. Double yellow lines will replace a certain length of permit holders parking space in Cathcart Street near its junction with Holmes Road to improve sight lines.
- (e) a Healthy School Street (timed motor vehicle restriction) on Cathcart Street between Holmes Road and between 8 and 32 Cathcart Street (operating Monday - Friday, 8am - 9am and 3:30pm -4:30pm) to discourage car trips, particularly amongst parents and carers and provide a safe and inviting space for more walking, cycling and scooting outside Collège Français Bilingue de Londres. Double yellow lines will replace certain lengths of permit holders parking space near to the start of the restrictions to allow space for vehicles to turn around.

It is proposed that the ETO for the scheme would be in place for 18 months. The Council will carry out a full public consultation after the experimental scheme has been in place for approximately 12 months. This consultation will then, together with relevant information from other sources, inform the Council's decision as to what permanent measures may be taken for a permanent scheme, subject to funding. If approved, monitoring data will be collected on relevant streets in the general vicinity of the scheme before and during the trial.

LONDON BOROUGH OF CAMDEN

TRAFFIC MANAGEMENT ORDER

2024 No. 096

The Camden (Prescribed Routes) (Cathcart Street, Holmes Road and Willes Road)
(No. 1) Experimental Traffic Order 2024

Made: 28 November 2024

Coming into force: 13 January 2025

Expires: 12 July 2026

The Council of the London Borough of Camden, after consulting the Commissioner of Police of the Metropolis, in exercise of the powers conferred by sections 9 and 124 of and Part IV of Schedule 9 to the Road Traffic Regulation Act 1984¹, and of all other powers thereunto enabling, hereby make the following Order:

Citation, commencement and expiry

- 1.1 This Order may be cited as the Camden (Prescribed Routes) (Holm Cathcart Road, Holmes Road and Willes Road) (No. 1) Experimental Traffic Order 2024, shall come into force on 13 January 2025, and will expire on 12 July 2026.

Interpretation

- 2.1 In this Order:-

“bus” and “pedal cycle” has the same meanings as in Schedule 1 to the Traffic Signs Regulations and General Directions 2016²;

“causing” includes “permitting”;

“Council” means the Council of the London Borough of Camden;

“disabled persons badge” has the same meaning as in the Disabled Persons (Badges for Motor Vehicles) (England) Regulations 2000³;

“electric scooter” has the same meaning as in Schedule 1 to the Traffic Signs Regulations and General Directions 2016 as amended by the Electric Scooter Trials and Traffic Signs (Coronavirus) Regulations and General Directions 2020⁴;

“enactment” means any enactment, whether public general or local, and includes any order, byelaw, rule, regulation, scheme or other instrument having effect by virtue of an enactment

¹ 1984 c.27

² SI 2016/362

³ SI 2000/682

⁴ SI 2020/663

“motor vehicle” has the same meaning as in section 136 of the Road Traffic Regulation Act 1984;

“prescribed hours” means between 8 a.m. and 9 a.m. and between 3.30 p.m. and 4.30 p.m. on Mondays to Fridays inclusive.

- 2.2 Any reference in this Order to any enactment shall be construed as a reference to that enactment as amended, applied, consolidated, re-enacted by or as having effect by virtue of any subsequent enactment.

Provisions - prescribed routes

- 3.1 No person causing any motor vehicle to proceed in Holmes Road shall, upon reaching its junction with Cathcart Street, cause that motor vehicle to enter Cathcart Street.
- 3.2 No person causing any motor vehicle to proceed in a north-westbound direction in that part of Cathcart Street which lies south-east of a point 10 metres north-west of the party wall of Nos. 5 and 6 Cathcart Street shall, upon reaching that point, cause that motor vehicle to enter into that part of Cathcart Street which lies north-west of that point, during the prescribed hours.
- 3.3 No person causing any motor vehicle to proceed in a south-eastbound direction in that part of Willes Road which lies north-west of a point 4 metres south-east of the south-eastern kerb-line of Holmes Road shall, upon reaching that point, cause that motor vehicle to enter into that part of Willes Road which lies south-east of that point, during the prescribed hours.
- 3.4 No person causing any motor vehicle to proceed in a north-westbound direction in that part of Holmes Road which lies south-east of a point 4 metres north-west of the north-western kerb-line of Raglan Street shall, upon reaching that point, cause that motor vehicle to enter into that part of Holmes Road which lies north-west of that point.
- 3.5 No person causing any vehicle other than a pedal cycle to proceed in Inkerman Road shall, upon reaching its junction with that part of Willes Road that lies north-west of Inkerman Road, cause that vehicle to enter that part of Willes Road that lies north-west of Inkerman Road.
- 3.6 No person causing any vehicle other than a pedal cycle to proceed in that part of Willes Road that lies north-west of Inkerman Road shall, upon reaching its junction with Inkerman Road, cause that vehicle to enter Inkerman Road.

Exemptions

- 4.1 Nothing in Articles 3.1 to 3.6 inclusive shall apply in relation to:-
- (a) anything done with the permission or at the direction of a police constable;
 - (b) a vehicle being used by the ambulance, fire brigade or police purposes;
 - (c) any person who causes any vehicle to proceed in accordance with any restriction or requirement indicated by traffic signs placed pursuant to sections 66 or 67 of the Road Traffic Regulation Act 1984;
 - (d) a vehicle being used by or on behalf of the Council in the pursuance of its statutory duties;

- (e) a vehicle being used in connection with the removal of an obstruction to traffic;
- (f) an electric scooter;
- (g) any vehicle which may otherwise be authorised by the council.

4.2 Without prejudice to the exemptions set out above, nothing in Articles 3.2 or 3.3 shall apply in respect of:

- (a) any vehicle registered at a residential address within either:
 - (i) that part of Cathcart Street which lies between its junction with Holmes Road and the party wall of Nos. 7 and 8 Cathcart Street; or
 - (ii) that part of Holmes Road which lies between its junction with Raglan Street and a point 225 Willes Road north-west of the western kerb-line of Kentish Town Road;
- (b) any vehicle being used to transport a person resident in the sections of those streets described in sub-paragraph (a) above to whom a valid disabled persons' badge has been issued; or
- (c) any vehicle being used to transport a disabled pupil to or from St. Patrick's Catholic Primary School, Holmes Road or Collège Français Bilingue de Londres, Holmes Road;
- (d) a bus operating a 'Plus Bus door to door' or 'Dial-a-ride' service, when providing that service to a person or persons resident in the sections of those streets described in sub-paragraph (a) above.

Suspension or modification of this Order

5.1 In pursuance of section 10(2) of the Road Traffic Regulation Act 1984, the Highway Network Manager or some other person authorised in that behalf by him, may, if it appears to him or that other person essential in the interests of the expeditious, convenient and safe movement of traffic, or in the interests of providing suitable and adequate on-street parking facilities, or for preserving or improving the amenities of the area through which any road affected by this Order runs, modify or suspend the operation of this Order or any provision of it, save that no modification shall make an addition.

Dated this 28 November 2024

Peter Mardell



Head of Parking Operations

LONDON BOROUGH OF CAMDEN

TRAFFIC MANAGEMENT ORDER

2024 No. 097

The Camden (Parking Places) (CA-L) (Cathcart Street and Willes Road) (No. 1)
Experimental Traffic Order 2024

Made: 28 November 2024

Coming into force: 13 January 2025

Expiry: 12 July 2026

The Council of the London Borough of Camden, after consulting the Commissioner of Police of the Metropolis, in exercise of the powers conferred by sections 9 and 124 of and Part IV of Schedule 9 to the Road Traffic Regulation Act 1984¹, and of all other powers thereunto enabling, hereby make the following Order:

Citation, commencement and expiry

- 1.1 This Order may be cited as the Camden (Parking Places) (CA-L) (Cathcart Street and Willes Road) (No. 1) Experimental Traffic Order 2024, shall come into force on 13 January 2025, and will expire on 12 July 2026.

Interpretation

- 2.1 In this Order:

“enactment” means any enactment, whether public general or local, and includes any order, byelaw, rule, regulation, scheme or other instrument having effect by virtue of an enactment; and

“the Order of 2012” means the Camden (Parking Places) (CA-L) Traffic Order 2012², as amended.

- 2.2 Any reference in this Order to any other Order or enactment shall be construed as a reference to that Order or enactment as amended, applied, consolidated, re-enacted by, or as having effect by virtue of any subsequent Order or enactment;
- 2.3 Unless the context otherwise requires, any expression used in this Order which is also used in the Order of 2012 shall have the same meaning as in that Order.

¹ 1983 c.27

² LBC 2012/11

Suspension of and designation of parking places

- 3.1 Whilst this Order continues in force and without prejudice to the validity of anything done or to any liability incurred in respect of any act or omission before the coming into force of this Order, the Order of 2012 shall have effect as though:
- (a) the items numbered 4430 and 12953 (relating to Cathcart Street) and 13227 and 13237 (relating to Willes Road), were hereby suspended; and
 - (b) there were added to Schedule 1 to that Order, the items set out in the Schedule to this Order.

Suspension or modification of this Order

- 4.1 In pursuance of section 10(2) of the Road Traffic Regulation Act 1984, the Highway Network Manager or some other person authorised in that behalf by him, may, if it appears to him or that other person essential in the interests of the expeditious, convenient and safe movement of traffic, or in the interests of providing suitable and adequate on-street parking facilities, or for preserving or improving the amenities of the area through which any road affected by this Order runs, modify or suspend the operation of this Order or any provision of it, save that no modification shall make an addition.

Dated this 28 November 2024

Peter Mardell



Head of Parking Operations

SCHEDULE – PERMIT HOLDERS’ PARKING PLACES

(Additions to Schedule 1 to the Order of 2012)

<i>Item No. (1)</i>	<i>Street (2)</i>	<i>Length of highway (3)</i>	<i>Controlled hours (4)</i>
X1.	CATHCART STREET	north-east side: from a point 8.5 metres south-east of the south-eastern kerb-line of Holmes Road, south-eastwards for a distance of 10.5 metres.	Monday – Friday 8.30 am - 6.30 pm
X2.	CATHCART STREET	south-west side: from a point 13.1 metres north-west of a point opposite the south-eastern wall of No. 36 Inkerman Road to a point 0.6 metres north-west of the party wall of Nos. 5 and 6 Cathcart Street.	Monday – Friday 8.30 am - 6.30 pm
X3.	CATHCART STREET	south-west side: from a point 11.5 metres north-west of the party wall of Nos. 5 and 6 Cathcart Street to a point 2 metres north-west of the north-western wall of No. 9 Cathcart Street.	Monday – Friday 8.30 am - 6.30 pm
X4.	WILLES ROAD	south-west side, from a point 13.2 metres north-west of a point opposite the south-eastern wall of No. 38 Willes Road, north-westwards for a distance of 16.1 metres.	Monday – Friday 8.30 am - 6.30 pm
X5.	WILLES ROAD	north-east side: from the party wall of nos. 52 and 54 Willes Road, south-eastwards for a distance of 31.4 metres.	Monday – Friday 8.30 am - 6.30 pm

EXPLANATORY NOTE

(This Note is not part of the Order)

As part of the Council's 'safe and healthy streets' programme of cycling and walking highway improvement measures, this Order amends the provisions of the Camden (Parking Places) (CA-L) Traffic Order 2012, so as to remove lengths of existing 'CA-L' permit holders' parking places in Cathcart Street and Willes Road, in the London Borough of Camden.

LONDON BOROUGH OF CAMDEN

TRAFFIC MANAGEMENT ORDER

2024 No. 098

The Camden (Waiting Restrictions) (Cathcart Street and Willes Road)
(No. 1) Experimental Traffic Order 2024

Made: 28 November 2024

Coming into force: 13 January 2025

Expiry: 12 July 2026

The Council of the London Borough of Camden, after consulting the Commissioner of Police of the Metropolis, in exercise of the powers conferred by sections 9 and 124 of and Part IV of Schedule 9 to the Road Traffic Regulation Act 1984¹, and of all other powers thereunto enabling, hereby make the following Order:

Citation, commencement and expiry

- 1.1 This Order may be cited as the Camden (Waiting Restrictions) (Cathcart Street and Willes Road) (No. 1) Experimental Traffic Order 2024, shall come into force on 13 January 2025, and will expire on 12 July 2026.

Interpretation

- 2.1 In this Order:-

“enactment” means any enactment, whether public general or local, and includes any order, byelaw, rule, regulation, scheme or other instrument having effect by virtue of an enactment; and

“the Order of 2012” means The Camden (Waiting and Loading Restrictions) (Civil Enforcement Area) Traffic Order 2012², as amended.

- 2.2 Any reference in this Order to any enactment shall be construed as a reference to that enactment as amended, applied, consolidated, re-enacted by or as having effect by virtue of any subsequent enactment.
- 2.3 Unless the context otherwise requires, any expression used in this Order which is also used in the Order of 2012 shall have the same meaning as in that Order.

¹ 1984 c.27

² LBC 2012/1

Amendment of the Order of 2012

3.1 Whilst this Order continues in force and without prejudice to the validity of anything done or to any liability incurred in respect of any act or omission before the coming into force of this Order, the Order of 2012 shall have effect as though for the purposes of the current application of Article 3.1 of that Order to the lengths of street specified in the Schedule to this Order, the expression “prescribed hours” means at any time.

Suspension or modification of this Order

4.1 In pursuance of section 10(2) of the Road Traffic Regulation Act 1984, the Highway Network Manager or some other person authorised in that behalf by him, may, if it appears to him or that other person essential in the interests of the expeditious, convenient and safe movement of traffic, or in the interests of providing suitable and adequate on-street parking facilities, or for preserving or improving the amenities of the area through which any road affected by this Order runs, modify or suspend the operation of this Order or any provision of it, save that no modification shall make an addition.

Dated this 28 November 2024

Peter Mardell



Head of Parking Operations

SCHEDULE

Cathcart Street

- (a) the north-east side, between a point 1.4 metres south-east of the north-western wall of No. 87 Holmes Road and a point 6.9 metres south-east of that wall;
- (b) the south-west side, between a point 11.5 metres north-west of the party wall of Nos. 5 and 6 Cathcart Street and a point 0.6 metres north-west of that party wall.

Willes Road

- (a) the north-east side, between a point 2.5 metres north-west of the south-eastern wall of No. 38 Willes Road and a point 13.4 metres north-west of that wall;
- (b) the south-west side, between a point 1.6 metres north-west of a point opposite the south-eastern wall of No. 38 Willes Road and a point 13.2 metres north-west of a point opposite that wall.

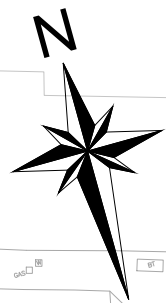

HOLMES ROAD

ST PATRICK'S CATHOLIC
PRIMARY SCHOOL

SCHOOL — KEEP — CLEAR













(S-01, S-02)



INSTALL EXPERIMENTAL MOTOR
VEHICLES PROHIBITED SIGN ON
EXISTING LAMP COLUMN AND
NEW POST TO PREVENT
WESTBOUND TRAFFIC ONLY

RAGLAN STREET

KEY

-  Install road markings
-  Install 150mm wide granite kerbs with 100mm upstand
-  Install 150mm wide flush granite kerbs
-  Install 600x600x63mm artificial stone paving slabs
-  Install 400x400mm buff tactiles
-  Existing road markings
-  Existing kerbs
-  Existing road markings to be removed
-  Existing kerb to be removed
-  Existing service covers to be adjusted to new finish level
-  Existing surface material to be excavated for ASP installation
-  Existing guardrail to be removed

FOR SIGNAGE INFORMATION REFER
TO SIGN SCHEDULE - SHEET 18 & 19

Rev	By	Date	Amendments

Camden
Design Team
 Transport Strategy Service
 London Borough of Camden
 5 Pancras Square
 Tel 020 7974 5551, Fax 020 7974 6952
 DX 2106 Euston, Minicom 020 7974 6866

DRAFT

Project
London Borough of Camden
Healthy School Streets
Holmes Road Area

Drawing Title
Holmes Road
ETO Drawing
Sheet 1 of 4

Scale 1:250 @ A3	Date APR 24
Drawn By JR	File Ref
Checked By JA	Dwg Name
Drawing Location	
Drawing Number	Rev.

A

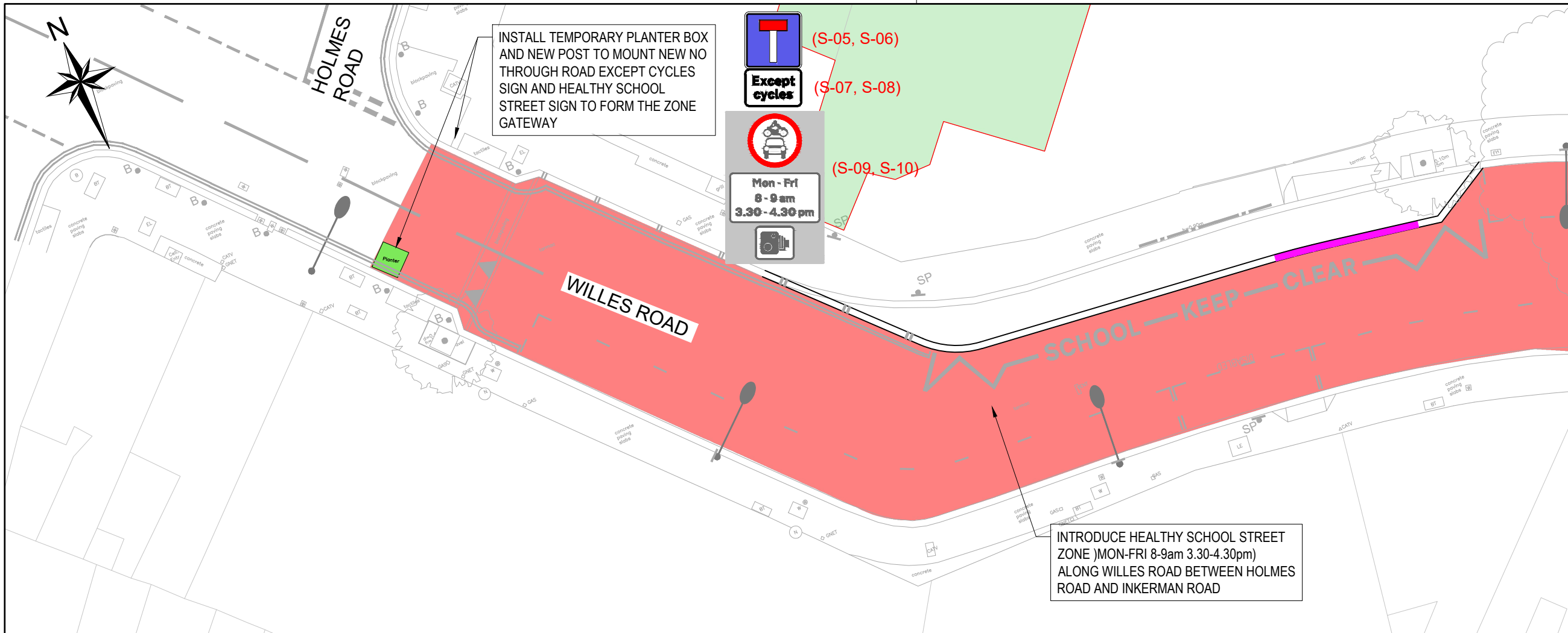

- KEY**
- Install road markings
 - Install 300mm wide granite kerbs with 100mm upstand
 - Install 300mm wide flush granite kerbs
 - Install 300mm wide flat concrete drainage channel
 - Install 600x600x63mm artificial stone paving slabs
 - Install fibre reinforced artificial stone paving slabs for vehicle crossover
 - Existing road markings
 - Existing kerbs
 - Existing road markings to be removed
 - Existing kerb to be removed
 - Existing service covers to be adjusted to new finish level
 - Existing surface material to be excavated for ASP installation
 - Existing guardrail to be removed

FOR SIGNAGE INFORMATION REFER TO SIGN SCHEDULE - SHEET 18 & 19

Rev	By	Date	Amendments

Camden
Design Team
 Transport Strategy Service
 London Borough of Camden
 5 Pancras Square
 Tel 020 7974 5551, Fax 020 7974 6952
 DX 2106 Euston, Minicom 020 7974 6866

DRAFT

Project
 London Borough of Camden
 Healthy School Streets
 Holmes Road Area

Drawing Title
 Willes Road
 ETO Drawing
 Sheet 2 of 4

Scale 1:200 @ A3	Date APR 24
Drawn By JR	File Ref
Checked By JA	Dwg Name
Drawing Location	
Drawing Number	Rev. A

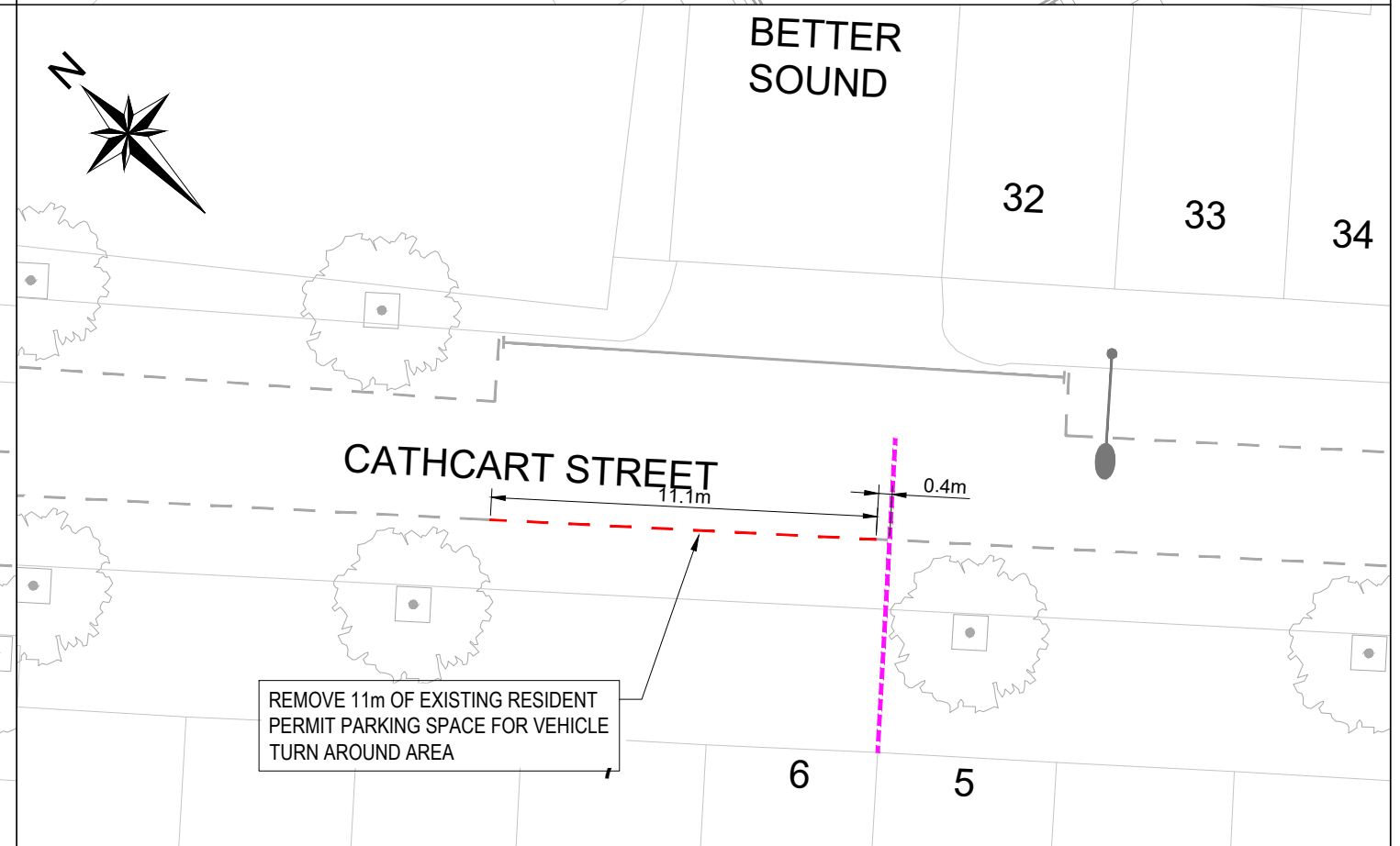
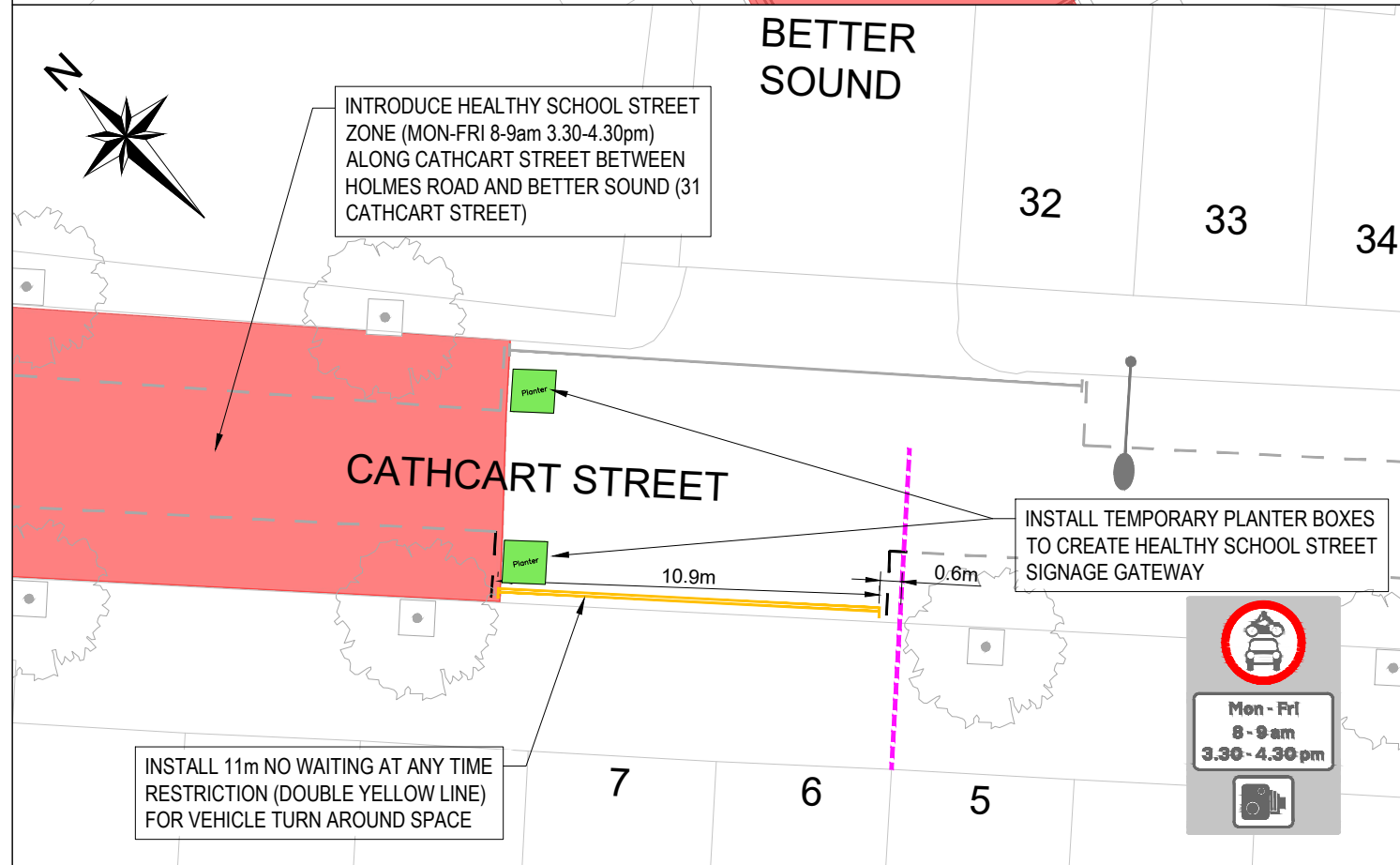
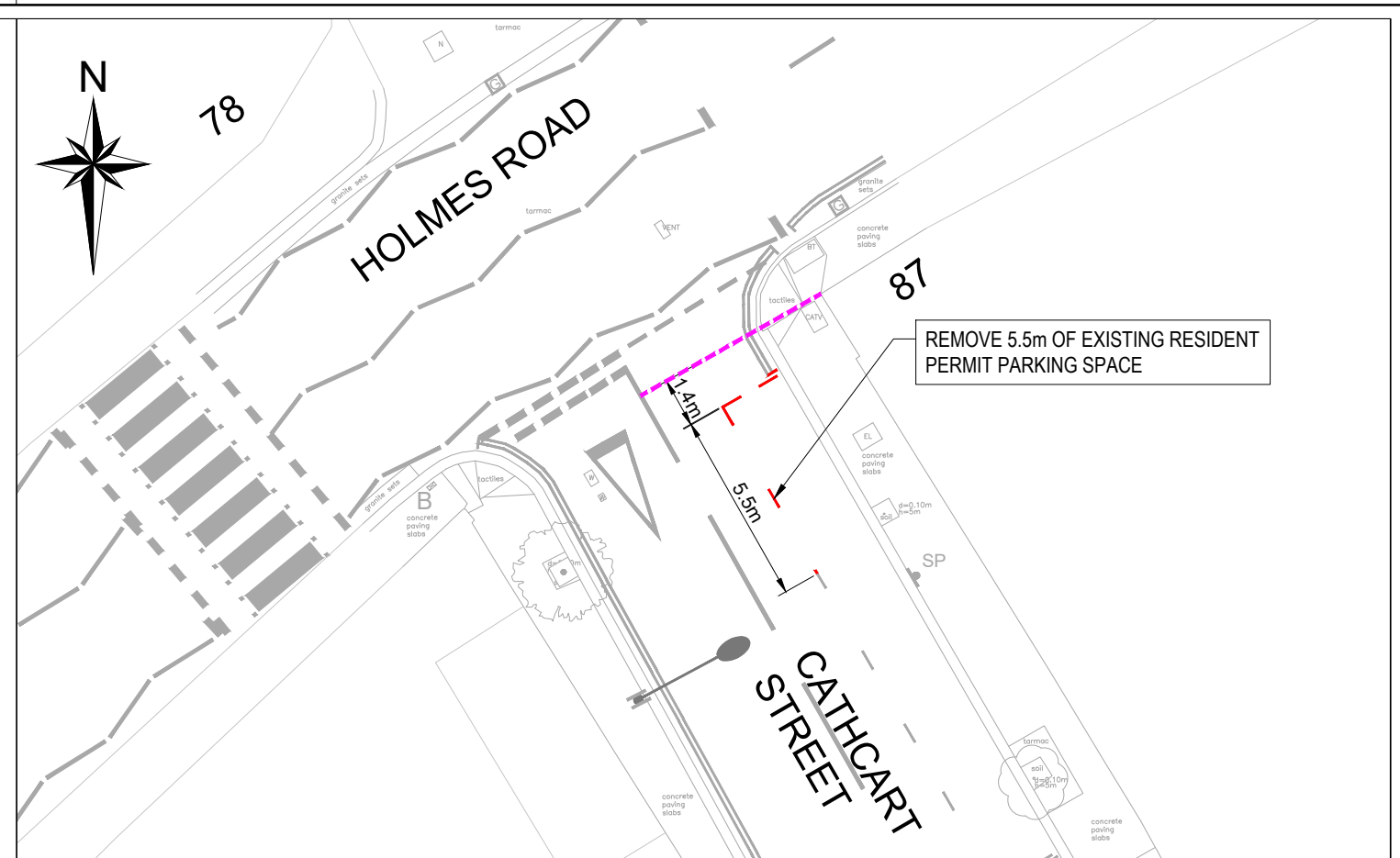
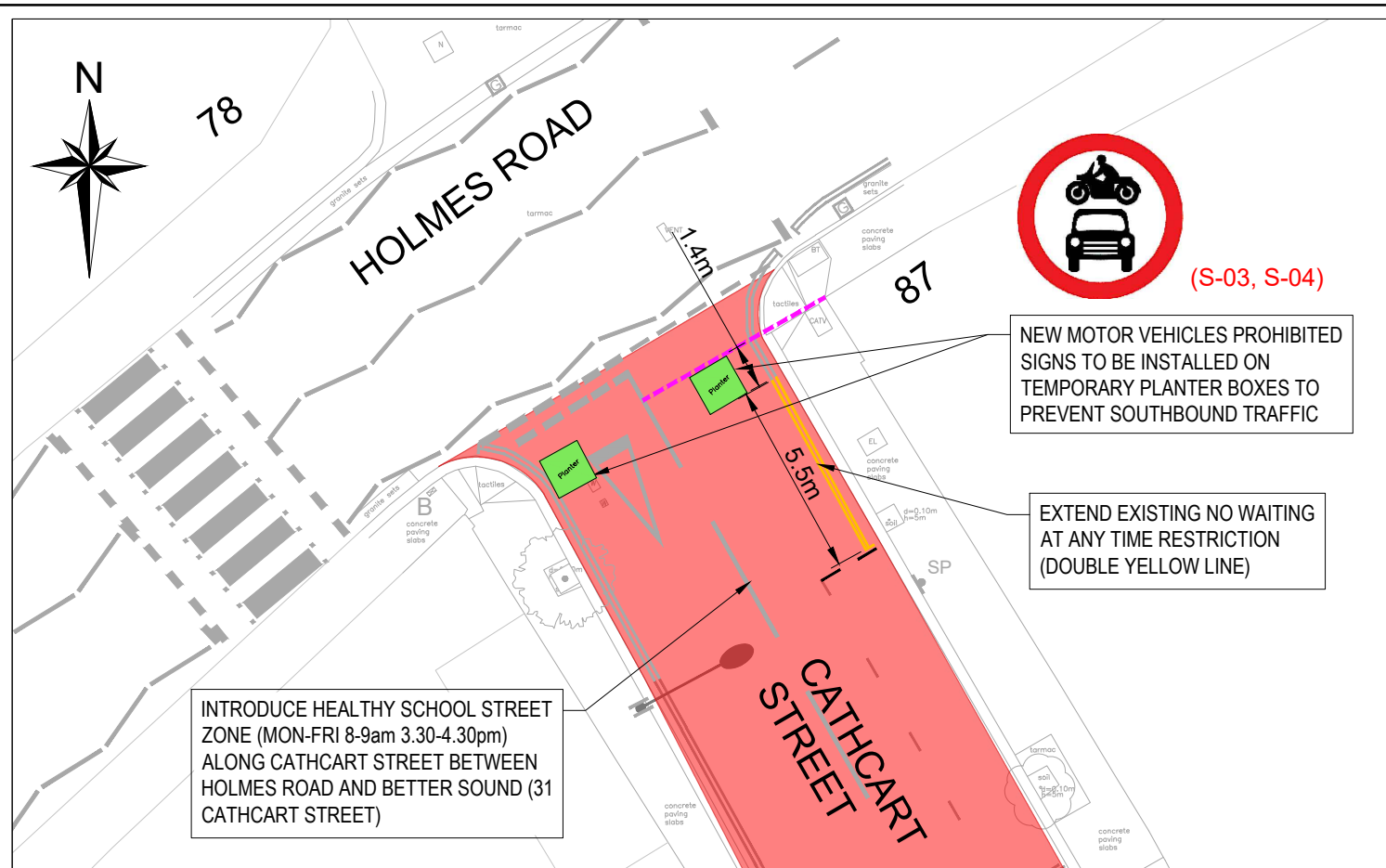

DRAFT

Rev	By	Date	Amendments

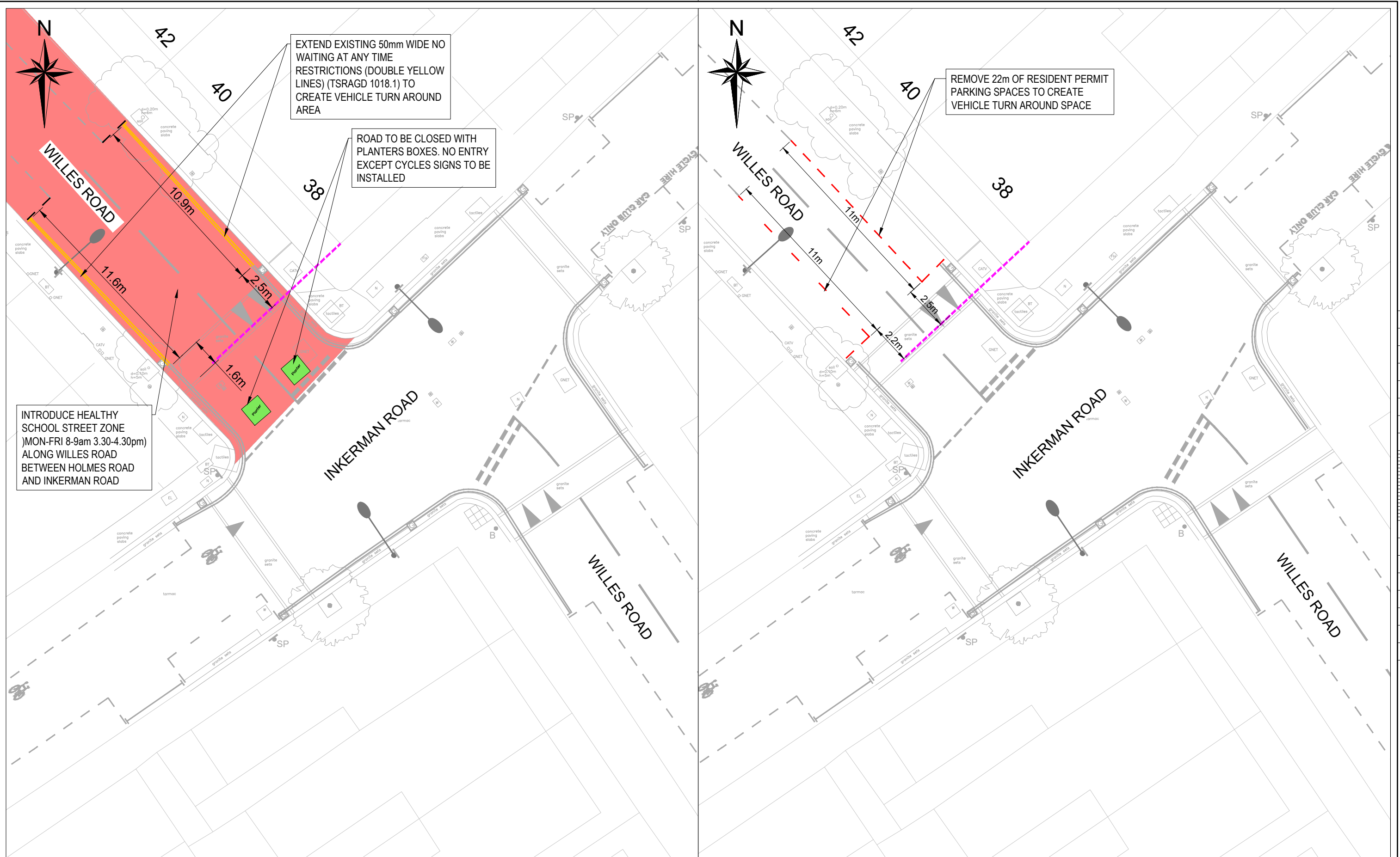

INTRODUCE HEALTHY SCHOOL STREET ZONE (MON-FRI 8-9am 3.30-4.30pm) ALONG WILLES ROAD BETWEEN HOLMES ROAD AND INKERMAN ROAD

EXTEND EXISTING 50mm WIDE NO WAITING AT ANY TIME RESTRICTIONS (DOUBLE YELLOW LINES) (TSRAGD 1018.1) TO CREATE VEHICLE TURN AROUND AREA

ROAD TO BE CLOSED WITH PLANTERS BOXES. NO ENTRY EXCEPT CYCLES SIGNS TO BE INSTALLED

REMOVE 22m OF RESIDENT PERMIT PARKING SPACES TO CREATE VEHICLE TURN AROUND SPACE

Camden
 Design Team
 Transport Strategy Service
 London Borough of Camden
 5 Pancras Square
 Tel 020 7974 5551, Fax 020 7974 6952
 DX 2106 Euston, Minicom 020 7974 6866

DRAFT

Project
 London Borough of Camden
 Healthy School Streets
 Holmes Road Area

Drawing Title
 Inkerman Road Junctions
 ETO Drawing
 Sheet 4 of 4

- Key**
- Install road markings
 - Install 150mm wide granite kerbs with 100mm upstand
 - Install 150mm wide flush granite kerbs
 - Install 600x600x63mm artificial stone paving slabs

- Existing road markings
- Existing kerbs
- Existing service covers to be adjusted to new finish level
- Install 400x400mm buff tactiles
- Existing service covers to be upgraded to recess cover

Rev	By	Date	Amendments

Scale 1:200 @ A3	Date APR 23
Drawn By JR	File Ref
Checked By JA	Dwg Name
Drawing Location	
Drawing Number	Rev. A