

The Camden (Belsize Lane) Experimental Traffic Order 2023
The Camden (Blossom House School) Experimental Traffic Order 2023
The Camden (Edith Neville School) Experimental Traffic Order 2023
The Camden (Lyndhurst Gardens) Experimental Traffic Order 2023
The Camden (Maria Fidelis School) Experimental Traffic Order 2023
The Camden (Regent High School) Experimental Traffic Order 2023

Notice is hereby given that the Council of the London Borough of Camden made the above mentioned orders on 15 May 2023 under Section 9 of the Road Traffic Regulation Act 1984, as amended. The orders will come into force on 25 May 2023. The general nature and effect of the orders will be to introduce prohibitions on entry by motor vehicles to the streets or sections of streets during the times specified below. All restrictions apply during school term times only.

The Camden (Belsize Lane) Experimental Traffic Order 2023

BELSIZE LANE (section between the junctions with Wedderburn Road and Ornan Road)

Times during which entry prohibition applies - Mondays to Fridays from 8am to 9.15am and from 3pm to 4pm.

The Camden (Blossom House School) Experimental Traffic Order 2023

WERRINGTON STREET (section between the projected south-eastern kerb line of Bridgeway Street and the projected south-eastern kerb line of Polygon Road)

POLYGON ROAD (section between the junction with Eversholt Street and the projected north-eastern kerb line of Werrington Street)

ALDENHAM STREET (whole street)

Times during which entry prohibition applies - Mondays to Fridays from 8am to 9.30am and from 3pm to 4pm.

The Camden (Edith Neville School) Experimental Traffic Order 2023

CHARRINGTON STREET (section south-east of the projected south-eastern kerb line of Platt Street)

PURCHASE STREET (section between the junction with Brill Place and the projected south-eastern kerb line of Chenies Place)

Times during which entry prohibition applies - Mondays to Fridays from 8am to 9.30am and from 3pm to 4pm.

The Camden (Lyndhurst Gardens) Experimental Traffic Order 2023

LYNDHURST GARDENS (section between the junctions with Lyndhurst Road and Wedderburn Road)

Times during which entry prohibition applies - Mondays to Fridays from 8am to 9.15am and from 3pm to 4pm

The Camden (Maria Fidelis School) Experimental Traffic Order 2023

DRUMMOND CRESCENT, DORIC WAY (whole streets)

Times during which entry prohibition applies - Mondays to Fridays from 8am to 9am and from 2.45pm to 4pm

The Camden (Regent High School) Experimental Traffic Order 2023

CHALTON STREET (section between the projected north-western kerb line of Bridgeway Street and the dead-end adjacent to Regent High School)

CRANLEIGH STREET (section north-east of the north-eastern kerb line of Werrington Street)

Times during which entry prohibition applies - Mondays to Fridays from 8am to 9.30am and from 3pm to 4pm

Exemptions to the entry restrictions will apply in respect of vehicles registered to properties only accessible by entering those streets or sections of streets, disabled badge holders living in the same sections, vehicles being used to transport disabled children to and from nearby schools, vehicles being used for police, ambulance or fire brigade purposes and any other vehicles which may be authorised by the council. In the case of the Camden (Regent High School) Experimental Traffic Order 2023, exemptions will also apply to vehicles for the general purposes of accessing premises in or adjacent to that section of Chalton Street specified.

The Council will be considering in due course whether the provisions of the experimental orders should be continued in force indefinitely. Within a period of six months beginning with the date on which the experimental orders come into force or, if the orders are varied by other orders or modified pursuant to section 10 (2) of the Road Traffic Regulation Act 1984, beginning with the day on which the variation or modification or the latest variation or modification came into force, any person may object to the making of an order for the purpose of such indefinite continuation.

Any such objection must be made in writing, stating the grounds on which the objection is being made and sent to safetravel@camden.gov.uk or by post to FREEPOST LBC Transport Strategy. Copies of the orders and other documents relating to the order may be inspected at [camden.gov.uk/recently-advertised-proposals](https://www.camden.gov.uk/recently-advertised-proposals) or by contacting traffic.orders@camden.gov.uk or may be inspected in person by appointment only at 5 Pancras Square, London, N1C 4AG, between the hours of 9am and 5pm on Mondays to Fridays excluding bank and public holidays (please contact traffic.orders@camden.gov.uk or 020-7974 4788 or 020-7974 5800 to arrange an appointment). Any person desiring to question the validity of any of the orders or of any provision contained therein on the grounds that it is not within the powers conferred by the Road Traffic Regulation Act 1984 or that any of the relevant requirements thereof or of any relevant regulations made thereunder has not

been complied with may, within 6 weeks of the date on which the order was made, make application for the purpose to the High Court.

Peter Mardell
Head of Parking Operations
18 May 2023

Statement of Reasons – St Christopher’s School Healthy School Street

As part of the Healthy School Street programme, a trial Healthy School Street scheme for St Christopher’s School is being introduced under an Experimental Traffic Order (ETO). Healthy School Street schemes aim to reduce the amount of traffic directly outside schools at drop off/pick up times, creating a safer and more welcoming environment and encouraging the use of active and sustainable modes of transport.

The St Christopher’s School Healthy School Street motor vehicle restriction will be in place on Belsize Lane between the junctions with Wedderburn Road and Ornan Road on weekdays during school term time between 8am – 9.15am and 3pm – 4pm:

The implementation of the proposed trial motor vehicle restrictions is aimed to reduce the amount traffic outside the school at key school run times. The reduction in traffic could have associated positive impacts on road safety and walking, cycling and scooting conditions for residents, school children, workers, and visitors to the area, and could help to improve air quality in these local streets.

Residents living on the section of Belsize Lane subject to the Healthy School Street restrictions will be able to apply for an exemption to the scheme so that they can still access their home by motor vehicle at all times. Penalty Charge Notices will not be issued to anybody driving out of the scheme area. Deliveries and visits from friends/relatives will need to be scheduled outside of the operational hours of the scheme. Plus Bus Door to Door and Dial A Ride services will be exempt, and exemptions will be available for Blue Badge holders that require access to an address within the Healthy School Street, carers, and residents that are reliant on door to door transport.

The ETO for the scheme will be in place for 18 months. Monitoring data will be collected during this time to understand the impacts of the scheme on streets within and outside the scheme area. The decision regarding whether or not to make the scheme permanent at the end of the trial will be based on monitoring data, feedback received during the trial period, Council policy and strategies.

The Camden (Blossom House School) Experimental Traffic Order 2023

Statement of Reasons – Blossom House Healthy School Street

As part of the Healthy School Street and Somers Town Future Neighbourhood programme, trial Healthy School Street schemes will be introduced at a number of locations in Somers Town under Experimental Traffic Orders (ETOs). Healthy School Street schemes aim to reduce the amount of traffic directly outside schools at drop off/pick up times, creating a safer and more welcoming environment and encouraging the use of active and sustainable modes of transport.

The Blossom House Healthy School Street motor vehicle restrictions will be in place on the following streets on weekdays during school term time between 8am – 9.30am and 3pm – 4pm:

- Werrington Street from the junction with Bridgeway Street to, and including, the junction with Polygon Road.
- Polygon Road from the junction with Eversholt Street to the junction with Chalton Street.
- Aldenham Street in its entirety

The implementation of the proposed trial motor vehicle restrictions is aimed to reduce the amount traffic in the local area at key school run times. The reduction in traffic could have associated positive impacts on road safety and walking, cycling and scooting conditions for residents, school children, workers, and visitors to the area, and could help to improve air quality in these local streets.

Healthy School Street restrictions on the section of Polygon Road between Werrington Street and Chalton Street were introduced as a trial in September 2021 and were made permanent in December 2022. We will simultaneously be consulting on amending the hours of the existing closure to align with the closure hours being introduced in nearby streets and the section of Polygon Road between Werrington Street and Eversholt Street under this ETO.

Residents living on the sections of the streets subject to the Healthy School Street restrictions will be able to apply for an exemption the scheme so that they can still access their homes by motor vehicle at all times. Penalty Charge Notices will not be issued to anybody driving out of the scheme area. Deliveries and visits from friends/relatives will need to be scheduled outside of the operational hours of the scheme. Plus Bus Door to Door and Dial A Ride services will be exempt, and exemptions would be available for Blue Badge holders that require access to an address within the Healthy School Street, carers, and residents that are reliant on door to door transport.

The ETO for the scheme will be in place for 18 months. Monitoring data will be collected during this time to understand the impacts of the scheme on streets within and outside the scheme area. The decision regarding whether or not to make the scheme permanent at the end of the trial will be based on monitoring data, feedback received during the trial period, Council policy and strategies.

The Camden (Edith Neville School) Experimental Traffic Order 2023

Statement of Reasons

As part of the Healthy School Streets programme, a trial Healthy School Street scheme will be introduced as set out below under an Experimental Traffic Order (ETO). The scheme aims to reduce the amount of traffic directly outside the Edith Neville Primary School at drop off/pick up times, creating a safer and more welcoming environment and encouraging the use of active and sustainable modes of transport.

The trial Healthy School Street motor vehicle restrictions are as follows and will be in place weekdays during school term time between 8am – 9.30am and 3pm – 4pm:

- Edith Neville Primary School:
 - Purchase Street from the junction with Brill Place to the junction with Chenies Place.
 - Charrington Street, from the junction with Platt Street southwards.

The implementation of the proposed trial motor vehicle restrictions is aimed to reduce the amount traffic in the local area at key school run times. The reduction in traffic could have associated positive impacts on road safety and walking, cycling and scooting conditions for residents, school children, workers, and visitors to the area, and could help to improve air quality in these local streets.

Residents living on the sections of the streets subject to the Healthy School Street restrictions will be able to apply for an exemption to that specific element of the scheme so that they can still access their homes by motor vehicle at all times. Penalty Charge Notices will not be issued to anybody driving out of the scheme areas. Deliveries and visits from friends/relatives will need to be scheduled outside of the operational hours of the schemes but exemptions would apply for Plus Bus Door to Door and Dial A Ride services, and would be available for Blue Badge holders that need to access an address within one of the Healthy School Streets and carers of residents living within one of the Healthy School Streets.

The ETO for the scheme will be in place for 18 months. Monitoring data will be collected during this time to understand the impacts of the scheme on streets within and outside the scheme area. The decision regarding whether or not to make the scheme permanent at the end of the trial will be based on monitoring data, feedback received during the trial period, Council policy and strategies.

Statement of Reasons – Maria Montessori - Hampstead Healthy School Street

As part of the Healthy School Street programme, a trial Healthy School Street scheme for Maria Montessori – Hampstead is being introduced under an Experimental Traffic Order (ETO). Healthy School Street schemes aim to reduce the amount of traffic directly outside schools at drop off/pick up times, creating a safer and more welcoming environment and encouraging the use of active and sustainable modes of transport.

The Maria Montessori – Hampstead Healthy School Street motor vehicle restriction will be in place on Lyndhurst Gardens between the junctions with Wedderburn Road and Lyndhurst Road on weekdays during school term time between 8am – 9.15am and 3pm – 4pm:

The implementation of the proposed trial motor vehicle restrictions is aimed to reduce the amount traffic outside the school at key school run times. The reduction in traffic could have associated positive impacts on road safety and walking, cycling and scooting conditions for residents, school children, workers, and visitors to the area, and could help to improve air quality in these local streets.

Residents living on the section of Lyndhurst Gardens subject to the Healthy School Street restrictions will be able to apply for an exemption to the scheme so that they can still access their home by motor vehicle at all times. Penalty Charge Notices will not be issued to anybody driving out of the scheme area. Deliveries and visits from friends/relatives will need to be scheduled outside of the operational hours of the scheme. Plus Bus Door to Door and Dial A Ride services will be exempt, and exemptions will be available for Blue Badge holders that require access to an address within the Healthy School Street, carers, and residents that are reliant on door to door transport.

The ETO for the scheme will be in place for 18 months. Monitoring data will be collected during this time to understand the impacts of the scheme on streets within and outside the scheme area. The decision regarding whether or not to make the scheme permanent at the end of the trial will be based on monitoring data, feedback received during the trial period, Council policy and strategies.

The Camden (Maria Fidelis School) Experimental Traffic Order 2023

Statement of Reasons

As part of the Healthy School Streets programme, a trial Healthy School Street scheme will be introduced as set out below under an Experimental Traffic Order (ETO). The scheme aims to reduce the amount of traffic directly outside Maria Fidelis Catholic School at drop off/pick up times, creating a safer and more welcoming environment and encouraging the use of active and sustainable modes of transport.

The trial Healthy School Street motor vehicle restrictions are as follows and will be in place weekdays during school term time between 8am – 9am and 2.45pm – 4pm:

- Doric Way in its entirety
- Drummond Crescent in its entirety

The implementation of the proposed trial motor vehicle restrictions is aimed to reduce the amount traffic in the local area at key school run times. The reduction in traffic could have associated positive impacts on road safety and walking, cycling and scooting conditions for residents, school children, workers, and visitors to the area, and could help to improve air quality in these local streets.

Residents living on the streets subject to the Healthy School Street restrictions will be able to apply for an exemption so that they can still access their homes by motor vehicle at all times. Penalty Charge Notices will not be issued to anybody driving out of the scheme area. Deliveries and visits from friends/relatives will need to be scheduled outside of the operational hours of the scheme but exemptions would apply for Plus Bus Door to Door and Dial A Ride services, and will be available for Blue Badge holders that need to access an address within the Healthy School Street, as well as carers of residents living within the restricted area.

The ETO for the scheme will be in place for 18 months. Monitoring data will be collected during this time to understand the impacts of the scheme on streets within and outside the scheme area. The decision regarding whether or not to make the scheme permanent at the end of the trial will be based on monitoring data, feedback received during the trial period, Council policy and strategies.

Statement of Reasons – Regent High School Healthy School Street

As part of the Healthy School Street and Somers Town Future Neighbourhood programme, trial Healthy School Street schemes will be introduced at a number of locations in Somers Town under Experimental Traffic Orders (ETOs). Healthy School Street schemes aim to reduce the amount of traffic directly outside schools at drop off/pick up times, creating a safer and more welcoming environment and encouraging the use of active and sustainable modes of transport.

The Regent High School Healthy School Street motor vehicle restrictions will be in place on the following streets on weekdays during school term time between 8am – 9.30am and 3pm – 4pm:

- Chalton Street from the junction with Bridgeway Street northwards.
- Cranleigh Street from the junction of Chalton Street to the junction of Werrington Street.

The implementation of the proposed trial motor vehicle restrictions is aimed to reduce the amount traffic in the local area at key school run times. The reduction in traffic could have associated positive impacts on road safety and walking, cycling and scooting conditions for residents, school children, workers, and visitors to the area, and could help to improve air quality in these local streets.

Residents living on the sections of the streets subject to the Healthy School Street restrictions will be able to apply for an exemption to that specific element of the scheme so that they can still access their home by motor vehicle at all times. Anybody accessing the Safestore on Chalton Street will also be exempt. Penalty Charge Notices will not be issued to anybody driving out of the scheme area. Deliveries and visits from friends/relatives will need to be scheduled outside of the operational hours of the scheme. Plus Bus Door to Door and Dial A Ride services will be exempt, and exemptions would be available for Blue Badge holders that require access to an address within the Healthy School Street, carers, and residents that are reliant on door to door transport.

The ETO for the scheme will be in place for 18 months. Monitoring data will be collected during this time to understand the impacts of the scheme on streets within and outside the scheme area. The decision regarding whether or not to make the scheme permanent at the end of the trial will be based on monitoring data, feedback received during the trial period, Council policy and strategies.

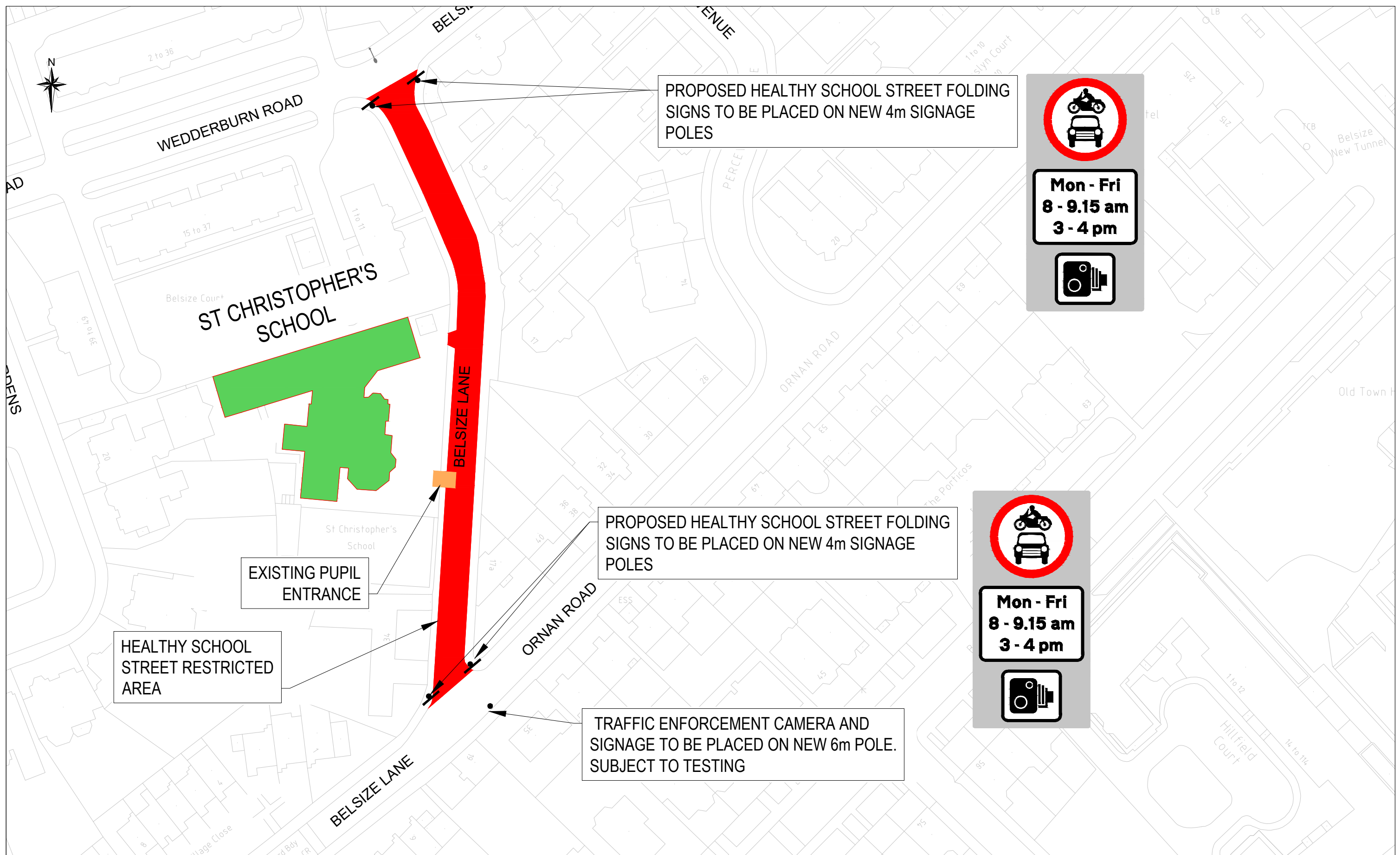

Rev	By	Date	Amendments

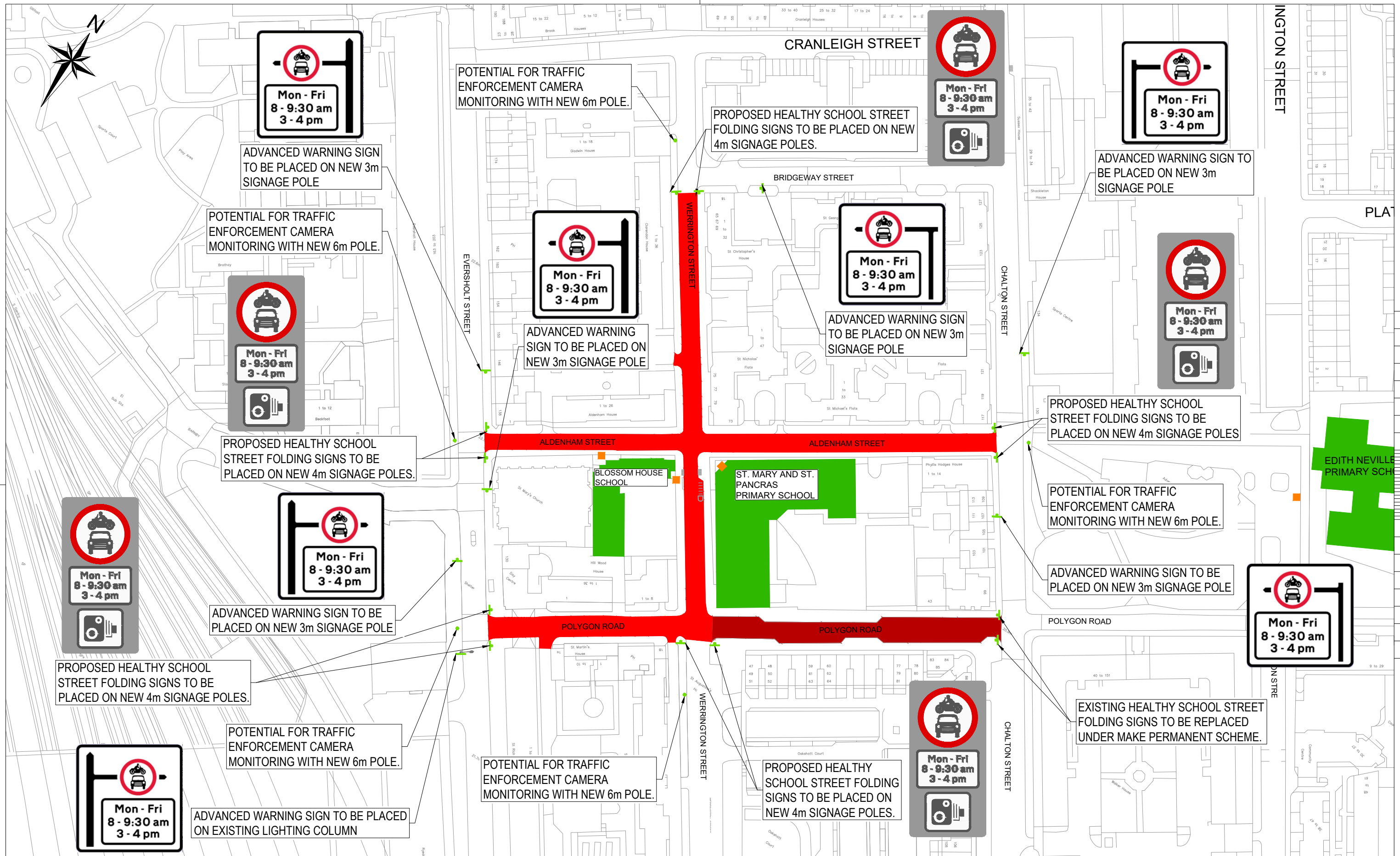

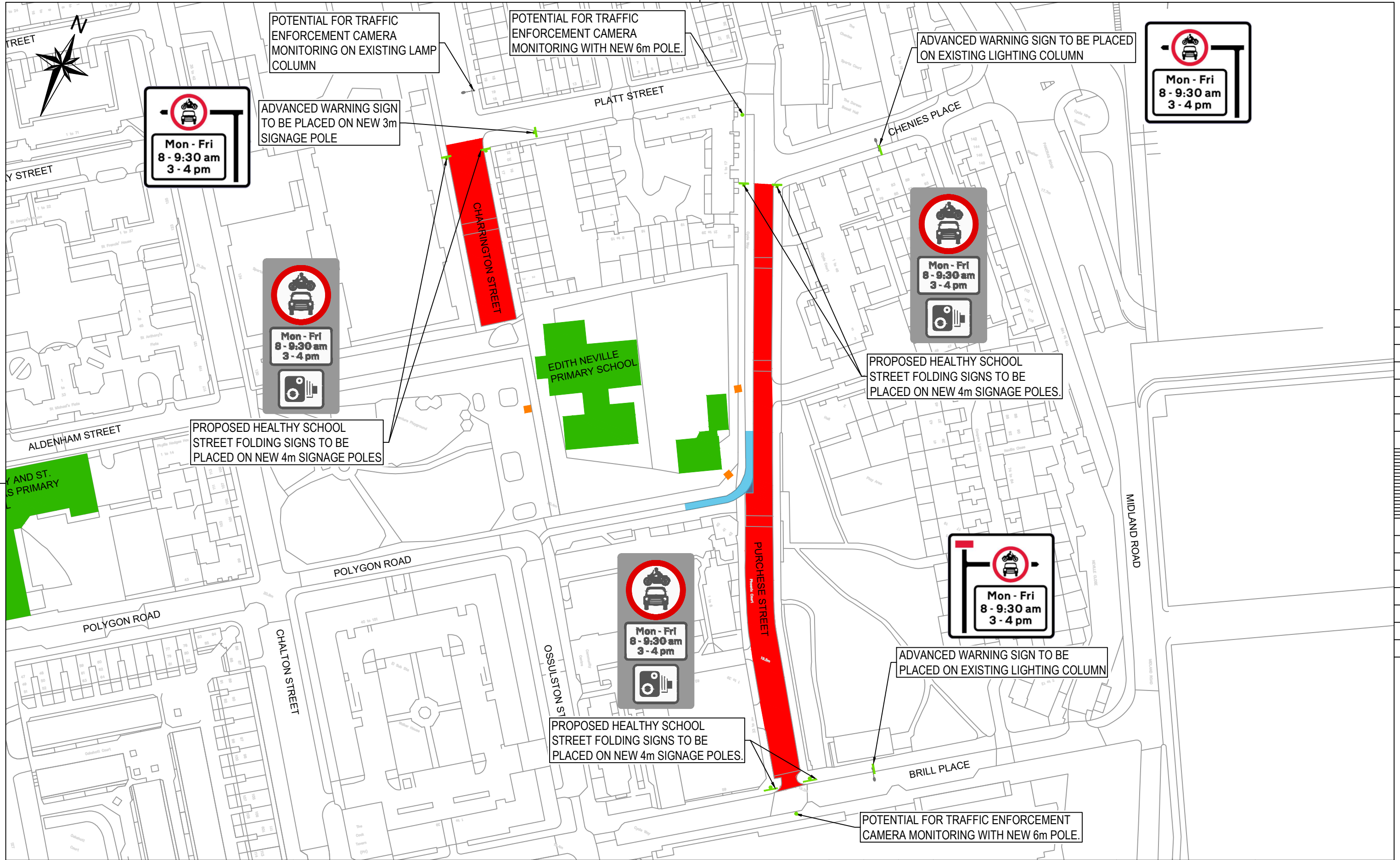

Rev	By	Date	Amendments

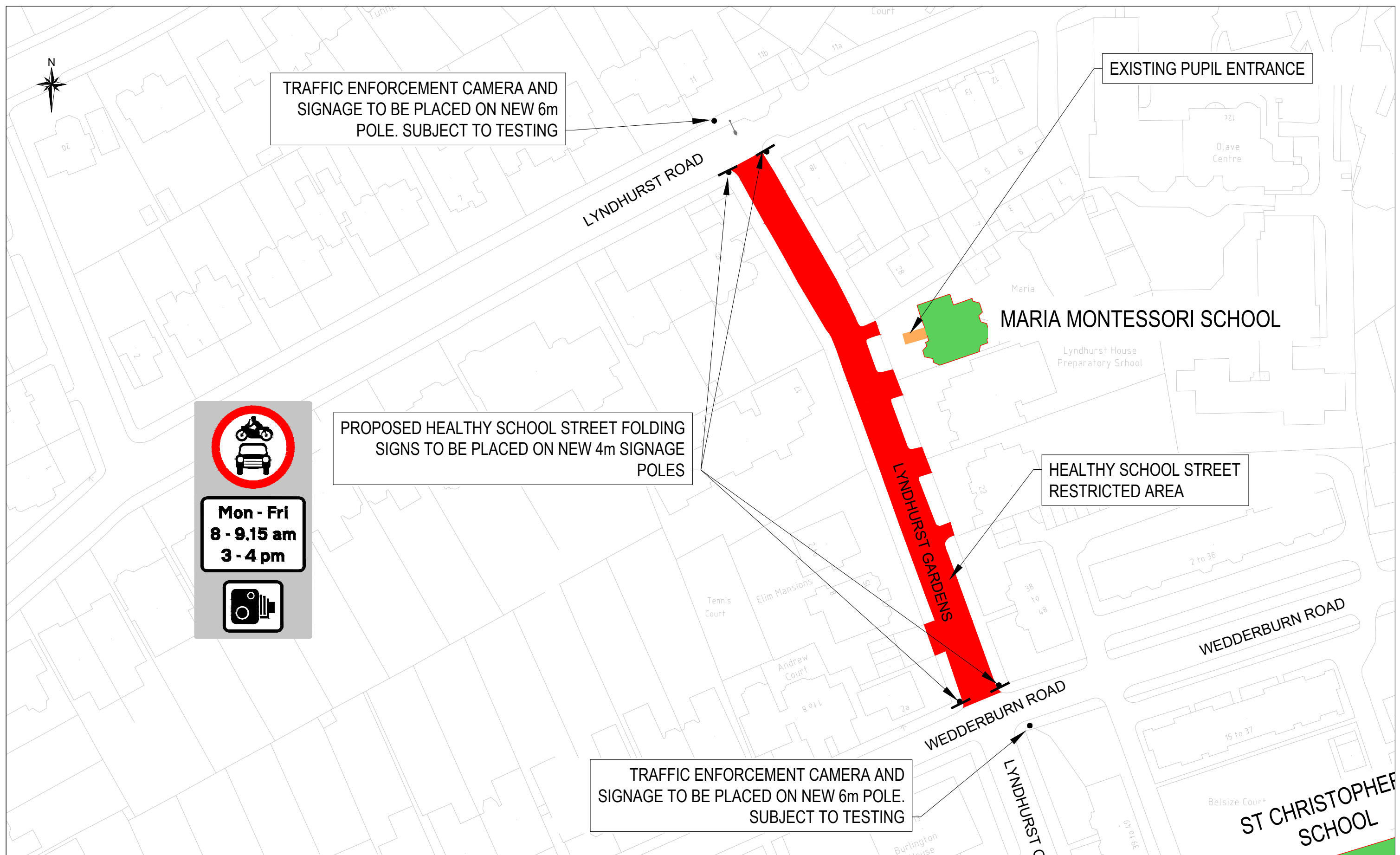

TRAFFIC ENFORCEMENT CAMERA AND SIGNAGE TO BE PLACED ON NEW 6m POLE. SUBJECT TO TESTING

EXISTING PUPIL ENTRANCE

MARIA MONTESSORI SCHOOL

PROPOSED HEALTHY SCHOOL STREET FOLDING SIGNS TO BE PLACED ON NEW 4m SIGNAGE POLES

HEALTHY SCHOOL STREET RESTRICTED AREA

TRAFFIC ENFORCEMENT CAMERA AND SIGNAGE TO BE PLACED ON NEW 6m POLE. SUBJECT TO TESTING

Rev	By	Date	Amendments

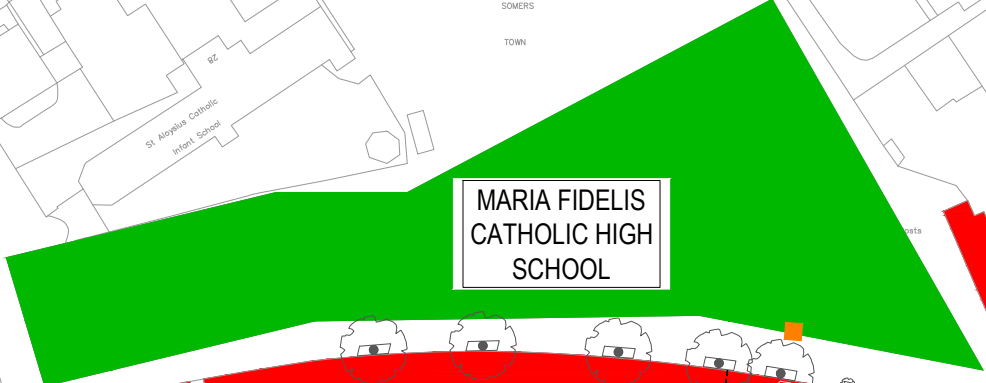

MARIA FIDELIS
CATHOLIC HIGH
SCHOOL



ADVANCED WARNING SIGN TO BE PLACED ON EXISTING LIGHTING COLUMN



PROPOSED HEALTHY SCHOOL STREET FOLDING SIGNS TO BE PLACED ON NEW 4m SIGNAGE POLES

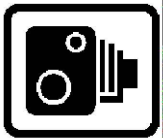

PROPOSED 6m POLE FOR ANPR CAMERA MONITORING AND SIGNAGE. EXISTING LIGHTING COLUMN IDENTIFIED FOR ANPR AND ICO SIGNAGE



ADVANCED WARNING SIGN TO BE PLACED ON NEW 3m SIGNAGE POLE

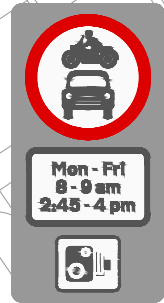

PROPOSED HEALTHY SCHOOL STREET FOLDING SIGNS TO BE PLACED ON EXISTING LIGHTING COLUMN

EXISTING BOLLARD CLOSURE TO REMAIN.

DRUMMOND CRESCENT

EVERSHOLT STREET

DORIC WAY

CHURCHWAY

CHALTON STREET



POTENTIAL URBAN GREEN SPACE SCHEME TO BE DEVELOPED, SUBJECT TO FUTURE CONSULTATION.

REGENT HIGH SCHOOL

PROPOSED LOW LEVEL PLANTERS OUTSIDE REGENT HIGH SCHOOL

PROPOSED HEALTHY SCHOOL STREET FOLDING SIGNS TO BE PLACED ON NEW 4m SIGNAGE POLES

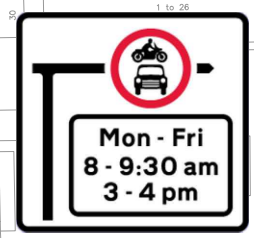
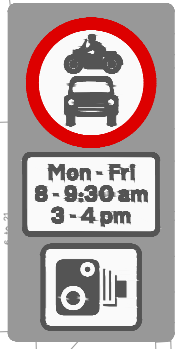

ADVANCED WARNING SIGN TO BE PLACED ON NEW 3m SIGNAGE POLE

ADVANCED WARNING SIGN TO BE PLACED ON EXISTING LIGHTING COLUMN

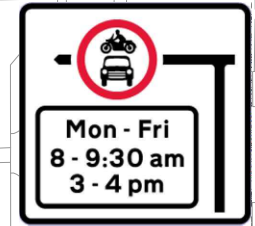

PROPOSED HEALTHY SCHOOL STREET FOLDING SIGNS TO BE PLACED ON NEW 4m SIGNAGE POLES

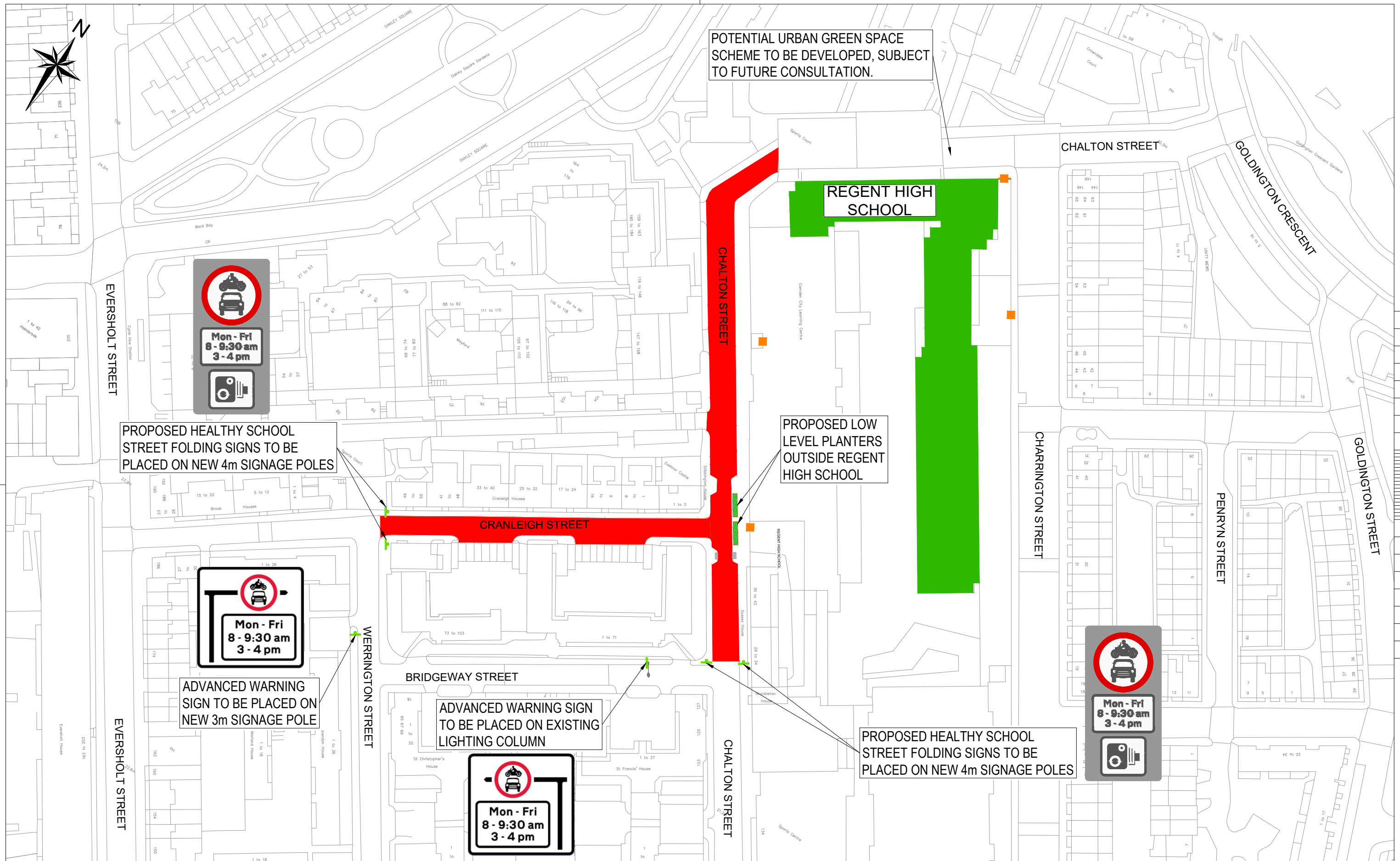
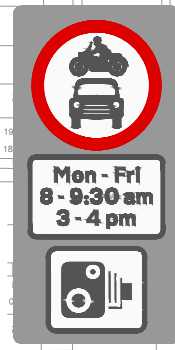

Rev	By	Date	Amendments

The Camden (Belsize Lane) Experimental Traffic Order 2023

2023 No. 58

LONDON BOROUGH OF CAMDEN

TRAFFIC MANAGEMENT ORDER

2023 No. 58

The Camden (Belsize Lane) Experimental Traffic Order 2023

Made on 15 May 2023

Coming into force on 25 May 2023

The Council of the London Borough of Camden, after consulting the Commissioner of Police of the Metropolis, in exercise of the powers conferred by section 9 of Road Traffic Regulation Act 1984 [1984 c. 27], and of all other powers thereunto enabling, hereby make the following order:

1. Citation and commencement

- 1.1 This order shall come into force on 25 May 2023 and may be cited as the Camden (Belsize Lane) Experimental Traffic Order 2023.

2. Interpretation

- 2.1 In this order the following terms have the meanings respectively ascribed to them;

"pedal cycle" has the same meaning as ascribed to it by the Traffic Signs Regulations and General Directions 2016 [S. I. 2016 No. 362].

"disabled persons badge" has the same meaning as in the Disabled Persons (Badges for Motor Vehicles) (England) Regulations 2000 [S. I. 2000 No. 682];

"school term times" means the term dates of the academic year as published by St. Christopher's School, Belsize Lane, or, if that school makes no such publication of the term dates, the London Borough of Camden in its capacity as the Local Education Authority.

- 2.2 Any reference in this order to any enactment shall be construed as a reference to that enactment as amended, applied, consolidated, re-enacted by or as having effect by virtue of any subsequent enactment.

3. Restrictions

- 3.1 No person shall cause any vehicle to enter the section of Belsize Lane which lies between its junctions with Wedderburn Road and Ornan Road, at those junctions, on Mondays to Fridays between 8 and 9.15am and between 3 and 4pm during school term times.

4. Exemptions

- 4.1 Nothing in Article 3.1 shall apply in respect of;
 - 4.1.1 a pedal cycle;
 - 4.1.2 anything done with the permission or at the direction of a police constable or traffic warden in uniform;
 - 4.1.3 a vehicle being used by the police, fire brigade or ambulance services;
 - 4.1.4 a council vehicle being used in the pursuance of statutory duties;
 - 4.1.5 any person who causes any vehicle to proceed in accordance with any restriction or requirement indicated by traffic signs placed pursuant to Section 66 or 67 of the Road Traffic Regulation Act 1984;
 - 4.1.6 any vehicle belonging to a resident living at an address in the section of Belsize Lane specified in Article 3.1, or an address to which vehicular access can only be obtained by entering that section of the road;
 - 4.1.7 any vehicle being used to transport a person resident at one of those addresses described in Article 4.1.6 and to whom a valid disabled persons' badge has been issued;
 - 4.1.8 any other vehicle which may otherwise be duly authorised by the council.

5. Power to modify or suspend this order

- 5.1 Pursuant to Section 10 (2) of the Act of 1984, the Director of Regeneration & Planning, Supporting Communities Directorate, or any person authorised by him may, if it appears to him or such other authorised person essential in the interest of the expeditious, convenient and safe movement of traffic, or in the provision of suitable and adequate parking, or for preserving or improving the amenities of the area through which any road affected by this order runs, modify or suspend this order or any of the provisions in this order.

Dated this 15 May 2023



**Peter Mardell
Head of Parking Operations**

The Camden (Blossom House School) Experimental Traffic Order 2023

2023 No. 59

LONDON BOROUGH OF CAMDEN

TRAFFIC MANAGEMENT ORDER

2023 No. 59

The Camden (Blossom House School) Experimental Traffic Order 2023

Made on 15 May 2023

Coming into force on 25 May 2023

The Council of the London Borough of Camden, after consulting the Commissioner of Police of the Metropolis, in exercise of the powers conferred by section 9 of Road Traffic Regulation Act 1984 [1984 c. 27], and of all other powers thereunto enabling, hereby make the following order:

1. Citation and commencement

- 1.1 This order shall come into force on 25 May 2023 and may be cited as the Camden (Blossom House School) Experimental Traffic Order 2023.

2. Interpretation

- 2.1 In this order the following terms have the meanings respectively ascribed to them;

"pedal cycle" has the same meaning as ascribed to it by the Traffic Signs Regulations and General Directions 2016 [S. I. 2016 No. 362].

"disabled persons badge" has the same meaning as in the Disabled Persons (Badges for Motor Vehicles) (England) Regulations 2000 [S. I. 2000 No. 682];

"school term times" means the term dates of the academic year as published by Blossom House School, Aldenham Street, or, if that school makes no such publication of the term dates, the London Borough of Camden in its capacity as the Local Education Authority.

- 2.2 Any reference in this order to any enactment shall be construed as a reference to that enactment as amended, applied, consolidated, re-enacted by or as having effect by virtue of any subsequent enactment.

3. Restrictions

- 3.1 No person shall cause any vehicle to enter Aldenham Street on Mondays to Fridays between 8 and 9.30am and between 3 and 4pm during school term times.
- 3.2 No person shall cause any vehicle to enter that section of Werrington Street which lies between the projected south-eastern kerb line of Bridgeway Street and the projected south-eastern kerb line of Polygon Road on Mondays to Fridays between 8 and 9.30am and between 3 and 4pm during school term times.

- 3.3 No person shall cause any vehicle to enter that section of Polygon Road which lies between its junction with Eversholt Street and the projected north-eastern kerb line of Werrington Street on Mondays to Fridays between 8 and 9.30am and between 3 and 4pm during school term times.

4. Exemptions

- 4.1 Nothing in Article 3.1 shall apply in respect of;
- 4.1.1 a pedal cycle;
- 4.1.2 anything done with the permission or at the direction of a police constable or traffic warden in uniform;
- 4.1.3 a vehicle being used by the police, fire brigade or ambulance services;
- 4.1.4 a council vehicle being used in the pursuance of statutory duties;
- 4.1.5 any person who causes any vehicle to proceed in accordance with any restriction or requirement indicated by traffic signs placed pursuant to Section 66 or 67 of the Road Traffic Regulation Act 1984;
- 4.1.6 any vehicle belonging to a resident living at an address in those streets, or sections of streets, specified in Article 3, or an address to which vehicular access can only be obtained by entering those streets or sections of streets.
- 4.1.7 any vehicle being used to transport a person resident at one of those addresses described in Article 4.1.6 and to whom a valid disabled persons' badge has been issued;
- 4.1.8 any other vehicle which may otherwise be duly authorised by the council.

5. Power to modify or suspend this order

- 5.1 Pursuant to Section 10 (2) of the Act of 1984, the Director of Regeneration & Planning, Supporting Communities Directorate, or any person authorised by him may, if it appears to him or such other authorised person essential in the interest of the expeditious, convenient and safe movement of traffic, or in the provision of suitable and adequate parking, or for preserving or improving the amenities of the area through which any road affected by this order runs, modify or suspend this order or any of the provisions in this order.

Dated this 15 May 2023



Peter Mardell
Head of Parking Operations

The Camden (Edith Neville School) Experimental Traffic Order 2023

2023 No. 60

LONDON BOROUGH OF CAMDEN

TRAFFIC MANAGEMENT ORDER

2023 No. 60

The Camden (Edith Neville School) Experimental Traffic Order 2023

Made on 15 May 2023

Coming into force on 25 May 2023

The Council of the London Borough of Camden, after consulting the Commissioner of Police of the Metropolis, in exercise of the powers conferred by section 9 of Road Traffic Regulation Act 1984 [1984 c. 27], and of all other powers thereunto enabling, hereby make the following order:

1. Citation and commencement

- 1.1 This order shall come into force on 25 May 2023 and may be cited as the Camden (Belsize Lane) Experimental Traffic Order 2023.

2. Interpretation

- 2.1 In this order the following terms have the meanings respectively ascribed to them;

"pedal cycle" has the same meaning as ascribed to it by the Traffic Signs Regulations and General Directions 2016 [S. I. 2016 No. 362].

"disabled persons badge" has the same meaning as in the Disabled Persons (Badges for Motor Vehicles) (England) Regulations 2000 [S. I. 2000 No. 682];

"school term times" means the term dates of the academic year as published by Edith Neville Primary School, Ossulston Street, or, if that school makes no such publication of the term dates, the London Borough of Camden in its capacity as the Local Education Authority.

- 2.2 Any reference in this order to any enactment shall be construed as a reference to that enactment as amended, applied, consolidated, re-enacted by or as having effect by virtue of any subsequent enactment.

3. Restrictions

- 3.1 No person shall cause any vehicle to enter the section of Charrington Street which lies south-east of the projected south-eastern kerb line of Platt Street on Mondays to Fridays between 8 and 9.30am and between 3 and 4pm during school term times.
- 3.2 No person shall cause any vehicle to enter that section of Purchase Street which lies between its junction with Brill Place and the projected south-eastern kerb line of

Chenies Place on Mondays to Fridays between 8 and 9.30am and between 3 and 4pm during school term times.

4. Exemptions

- 4.1 Nothing in Article 3.1 shall apply in respect of;
 - 4.1.1 a pedal cycle;
 - 4.1.2 anything done with the permission or at the direction of a police constable or traffic warden in uniform;
 - 4.1.3 a vehicle being used by the police, fire brigade or ambulance services;
 - 4.1.4 a council vehicle being used in the pursuance of statutory duties;
 - 4.1.5 any person who causes any vehicle to proceed in accordance with any restriction or requirement indicated by traffic signs placed pursuant to Section 66 or 67 of the Road Traffic Regulation Act 1984;
 - 4.1.6 any vehicle belonging to a resident living at an address in those sections of streets specified in Article 3, or an address to which vehicular access can only be obtained by entering those sections of streets;
 - 4.1.7 any vehicle being used to transport a person resident at one of those addresses described in Article 4.1.6 and to whom a valid disabled persons' badge has been issued;
 - 4.1.8 any other vehicle which may otherwise be duly authorised by the council.

5. Power to modify or suspend this order

- 5.1 Pursuant to Section 10 (2) of the Act of 1984, the Director of Regeneration & Planning, Supporting Communities Directorate, or any person authorised by him may, if it appears to him or such other authorised person essential in the interest of the expeditious, convenient and safe movement of traffic, or in the provision of suitable and adequate parking, or for preserving or improving the amenities of the area through which any road affected by this order runs, modify or suspend this order or any of the provisions in this order.

Dated this 15 May 2023



**Peter Mardell
Head of Parking Operations**

The Camden (Lyndhurst Gardens) Experimental Traffic Order 2023

2023 No. 61

LONDON BOROUGH OF CAMDEN

TRAFFIC MANAGEMENT ORDER

2023 No. 61

The Camden (Lyndhurst Gardens) Experimental Traffic Order 2023

Made on 15 May 2023

Coming into force on 25 May 2023

The Council of the London Borough of Camden, after consulting the Commissioner of Police of the Metropolis, in exercise of the powers conferred by section 9 of Road Traffic Regulation Act 1984 [1984 c. 27], and of all other powers thereunto enabling, hereby make the following order:

1. Citation and commencement

- 1.1 This order shall come into force on 25 May 2023 and may be cited as the Camden (Lyndhurst Gardens) Experimental Traffic Order 2023.

2. Interpretation

- 2.1 In this order the following terms have the meanings respectively ascribed to them;

"pedal cycle" has the same meaning as ascribed to it by the Traffic Signs Regulations and General Directions 2016 [S. I. 2016 No. 362].

"disabled persons badge" has the same meaning as in the Disabled Persons (Badges for Motor Vehicles) (England) Regulations 2000 [S. I. 2000 No. 682];

"school term times" means the term dates of the academic year as published by Maria Montessori School - Hampstead, Lyndhurst Gardens, or, if that school makes no such publication of the term dates, the London Borough of Camden in its capacity as the Local Education Authority.

- 2.2 Any reference in this order to any enactment shall be construed as a reference to that enactment as amended, applied, consolidated, re-enacted by or as having effect by virtue of any subsequent enactment.

3. Restrictions

- 3.1 No person shall cause any vehicle to enter the section of Lyndhurst Gardens which lies between its junctions with Lyndhurst Road and Wedderburn Road, at those junctions, on Mondays to Fridays between 8 and 9.15am and between 3 and 4pm during school term times.

4. Exemptions

- 4.1 Nothing in Article 3.1 shall apply in respect of;
 - 4.1.1 a pedal cycle;
 - 4.1.2 anything done with the permission or at the direction of a police constable or traffic warden in uniform;
 - 4.1.3 a vehicle being used by the police, fire brigade or ambulance services;
 - 4.1.4 a council vehicle being used in the pursuance of statutory duties;
 - 4.1.5 any person who causes any vehicle to proceed in accordance with any restriction or requirement indicated by traffic signs placed pursuant to Section 66 or 67 of the Road Traffic Regulation Act 1984;
 - 4.1.6 any vehicle belonging to a resident living at an address in the section of Lyndhurst Gardens specified in Article 3.1, or an address to which vehicular access can only be obtained by entering that section of the road;
 - 4.1.7 any vehicle being used to transport a person resident at one of those addresses described in Article 4.1.6 and to whom a valid disabled persons' badge has been issued;
 - 4.1.8 any other vehicle which may otherwise be duly authorised by the council.

5. Power to modify or suspend this order

- 5.1 Pursuant to Section 10 (2) of the Act of 1984, the Director of Regeneration & Planning, Supporting Communities Directorate, or any person authorised by him may, if it appears to him or such other authorised person essential in the interest of the expeditious, convenient and safe movement of traffic, or in the provision of suitable and adequate parking, or for preserving or improving the amenities of the area through which any road affected by this order runs, modify or suspend this order or any of the provisions in this order.

Dated this 15 May 2023



Peter Mardell
Head of Parking Operations

The Camden (Maria Fidelis School) Experimental Traffic Order 2023

2023 No. 62

LONDON BOROUGH OF CAMDEN

TRAFFIC MANAGEMENT ORDER

2023 No. 62

The Camden (Maria Fidelis School) Experimental Traffic Order 2023

Made on 15 May 2023

Coming into force on 25 May 2023

The Council of the London Borough of Camden, after consulting the Commissioner of Police of the Metropolis, in exercise of the powers conferred by section 9 of Road Traffic Regulation Act 1984 [1984 c. 27], and of all other powers thereunto enabling, hereby make the following order:

1. Citation and commencement

- 1.1 This order shall come into force on 25 May 2023 and may be cited as the Camden (Maria Fidelis School) Experimental Traffic Order 2023.

2. Interpretation

- 2.1 In this order the following terms have the meanings respectively ascribed to them;

"pedal cycle" has the same meaning as ascribed to it by the Traffic Signs Regulations and General Directions 2016 [S. I. 2016 No. 362].

"disabled persons badge" has the same meaning as in the Disabled Persons (Badges for Motor Vehicles) (England) Regulations 2000 [S. I. 2000 No. 682];

"school term times" means the term dates of the academic year as published by Maria Fidelis Catholic School FCJ, Drummond Crescent, or, if that school makes no such publication of the term dates, the London Borough of Camden in its capacity as the Local Education Authority.

- 2.2 Any reference in this order to any enactment shall be construed as a reference to that enactment as amended, applied, consolidated, re-enacted by or as having effect by virtue of any subsequent enactment.

3. Restrictions

- 3.1 No person shall cause any vehicle to enter Doric Way at its junction with Eversholt Street on Mondays to Fridays between 8 and 9am and between 2.45 and 4pm during school term times.

4. Exemptions

- 4.1 Nothing in Article 3 shall apply in respect of;

- 4.1.1 a pedal cycle;
- 4.1.2 anything done with the permission or at the direction of a police constable or traffic warden in uniform;
- 4.1.3 a vehicle being used by the police, fire brigade or ambulance services;
- 4.1.4 a council vehicle being used in the pursuance of statutory duties;
- 4.1.5 any person who causes any vehicle to proceed in accordance with any restriction or requirement indicated by traffic signs placed pursuant to Section 66 or 67 of the Road Traffic Regulation Act 1984;
- 4.1.6 any vehicle belonging to a resident living at an address in those streets specified in Article 3, or an address to which vehicular access can only be obtained by entering those streets.
- 4.1.7 any vehicle being used to transport a person resident at one of those addresses described in Article 4.1.6 and to whom a valid disabled persons' badge has been issued;
- 4.1.8 any other vehicle which may otherwise be duly authorised by the council.

5. Power to modify or suspend this order

- 5.1 Pursuant to Section 10 (2) of the Act of 1984, the Director of Regeneration & Planning, Supporting Communities Directorate, or any person authorised by him may, if it appears to him or such other authorised person essential in the interest of the expeditious, convenient and safe movement of traffic, or in the provision of suitable and adequate parking, or for preserving or improving the amenities of the area through which any road affected by this order runs, modify or suspend this order or any of the provisions in this order.

Dated this 15 May 2023



Peter Mardell
Head of Parking Operations

The Camden (Regent High School) Experimental Traffic Order 2023

2023 No. 63

LONDON BOROUGH OF CAMDEN

TRAFFIC MANAGEMENT ORDER

2023 No. 63

The Camden (Regent High School) Experimental Traffic Order 2023

Made on 15 May 2023

Coming into force on 25 May 2023

The Council of the London Borough of Camden, after consulting the Commissioner of Police of the Metropolis, in exercise of the powers conferred by section 9 of Road Traffic Regulation Act 1984 [1984 c. 27], and of all other powers thereunto enabling, hereby make the following order:

1. Citation and commencement

- 1.1 This order shall come into force on 25 May 2023 and may be cited as the Camden (Regent High School) Experimental Traffic Order 2023.

2. Interpretation

- 2.1 In this order the following terms have the meanings respectively ascribed to them;

"pedal cycle" has the same meaning as ascribed to it by the Traffic Signs Regulations and General Directions 2016 [S. I. 2016 No. 362].

"disabled persons badge" has the same meaning as in the Disabled Persons (Badges for Motor Vehicles) (England) Regulations 2000 [S. I. 2000 No. 682];

"school term times" means the term dates of the academic year as published by Regent High School, Chalton Street, or, if that school makes no such publication of the term dates, the London Borough of Camden in its capacity as the Local Education Authority.

- 2.2 Any reference in this order to any enactment shall be construed as a reference to that enactment as amended, applied, consolidated, re-enacted by or as having effect by virtue of any subsequent enactment.

3. Restrictions

- 3.1 No person shall cause any vehicle to enter that section of Chalton Street which lies north-west of the projected north-eastern kerb line of Bridgeway Street on Mondays to Fridays between 8 and 9.30am and between 3 and 4pm during school term times.
- 3.2 No person shall cause any vehicle to enter that section of Cranleigh Street which lies north-east of the projected north-western kerb line of Werrington Street and its

junction with Chalton Street on Mondays to Fridays between 8 and 9.30am and between 3 and 4pm during school term times.

4. Exemptions

- 4.1 Nothing in Article 3.1 shall apply in respect of;
 - 4.1.1 a pedal cycle;
 - 4.1.2 anything done with the permission or at the direction of a police constable or traffic warden in uniform;
 - 4.1.3 a vehicle being used by the police, fire brigade or ambulance services;
 - 4.1.4 a council vehicle being used in the pursuance of statutory duties;
 - 4.1.5 any person who causes any vehicle to proceed in accordance with any restriction or requirement indicated by traffic signs placed pursuant to Section 66 or 67 of the Road Traffic Regulation Act 1984;
 - 4.1.6 any vehicle belonging to a resident living at an address in those streets, or sections of streets, specified in Article 3, or an address to which vehicular access can only be obtained by entering those streets or sections of streets.
 - 4.1.7 any vehicle being used to transport a person resident at one of those addresses described in Article 4.1.6 and to whom a valid disabled persons' badge has been issued;
 - 4.1.8 any vehicle being used for the purposes of gaining access to premises in or adjacent to those sections of streets specified in Article 3.
 - 4.1.9 any other vehicle which may otherwise be duly authorised by the council.

5. Power to modify or suspend this order

- 5.1 Pursuant to Section 10 (2) of the Act of 1984, the Director of Regeneration & Planning, Supporting Communities Directorate, or any person authorised by him may, if it appears to him or such other authorised person essential in the interest of the expeditious, convenient and safe movement of traffic, or in the provision of suitable and adequate parking, or for preserving or improving the amenities of the area through which any road affected by this order runs, modify or suspend this order or any of the provisions in this order.

Dated this 15 May 2023



Peter Mardell
Head of Parking Operations