

The Camden (Chalk Farm Road and Neighbouring Streets) (Modification No. 3) Experimental Traffic Order 2021

Notice is hereby given that, on 5 July 2021, the Council of the London Borough of Camden made the above mentioned modification order to the Camden (Chalk Farm Road and Neighbouring Streets) Experimental Traffic Order 2020 which came into force on 23 July 2020. The modification order will come into force on 15 July 2021. The general nature and effect of the modification order will be to designate the parking place in Hawley Street at the side of no. 19 Chalk Farm Road for “pay-by-phone” use only and to reduce the designated length of the parking place outside Broomfield to 24.5 metres.

The Council will be considering in due course whether the provisions of the experimental order should continue in force indefinitely. Within a period of six months beginning with the date on which this modification to the experimental order comes into force or, if the order is varied by other orders or modified pursuant to section 10 (2) of the Road Traffic Regulation Act 1984 beginning with the day on which the variation or modification or the latest variation or modification came into force, any person may object to the making of an order for the purpose of such indefinite continuation. Any such objection must be made in writing, stating the grounds on which the objection is being made and sent to safetravel@camden.gov.uk or by post to FREEPOST LBC Transport Strategy. Copies of the orders and other documents related to this scheme may be inspected at camden.gov.uk/recently-advertised-proposals or obtained by contacting traffic.orders@camden.gov.uk

Peter Mardell
Head of Parking Operations
8 July 2021

**The Camden (Chalk Farm Road and Neighbouring Streets) (Modification No.3)
Experimental Traffic Order 2021**

STATEMENT OF REASONS

The Camden (Chalk Farm Road and Neighbouring Streets) Experimental Traffic Order 2020 came into force on 23 July 2020 and this modification order re-designates two parking places in Hawley Street and Ferdinand Street according to design changes resulting from feedback received by officers whilst the experimental scheme has been in operation.

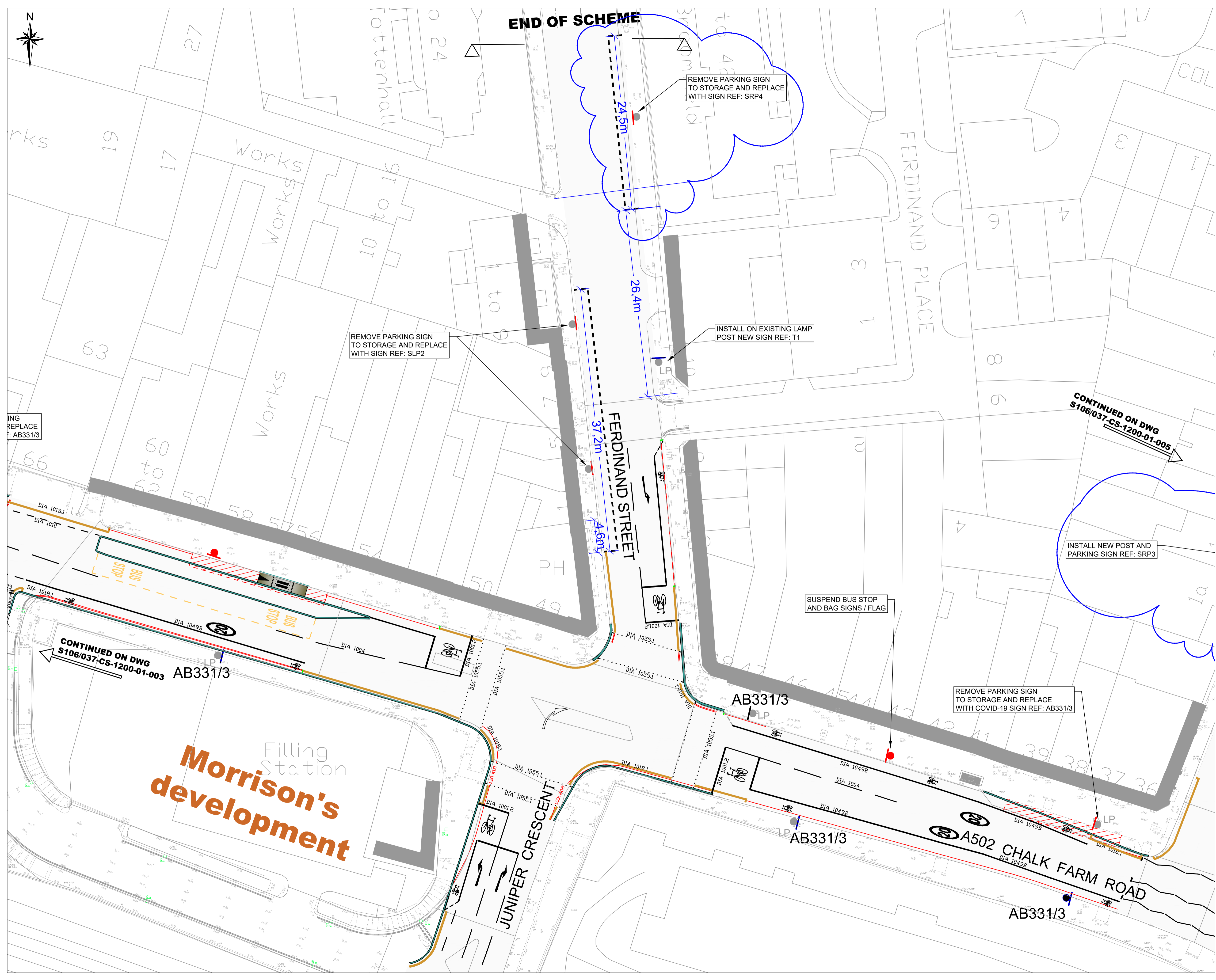

- KEY:**
- Install new post and sign (check signage reference)
 - Install new sign on existing post
 - Install new sign on existing lamp post
 - Remove post to tip and sign to storage
 - Remove sign form existing post to storage
 - Remove sign form existing lamp post to storage
 - New or refreshed bay markings
 - Buffer area between bay and cycle lane

- AB331/3**
- P1** Mon-Fri 8.30am-11pm, Sat-Sun 9.30am-11pm pay by phone 020 3003 2532 quoting location **14146** (Harland Rd), max stay 2 hours
 - P2** Mon-Fri 8.30am-11pm, Sat-Sun 9.30am-11pm pay by phone 020 3003 2532 quoting location **14447**(Harwood St), max stay 2 hours
 - SRP3** Mon-Fri 8.30am-11pm, Sat-Sun 9.30am-11pm permit holders CA-F or pay by phone 020 3003 2532 quoting location **14147** (Harwood St), max stay 2 hours
 - SRP4** Mon-Fri 8.30am-11pm, Sat-Sun 9.30am-11pm permit holders CA-F or pay by phone 020 3003 2532 quoting location **14148** (Ferdinand St), max stay 2 hours
 - SRP5** Mon-Fri 8.30am-11pm, Sat-Sun 9.30am-11pm permit holders CA-F or pay by phone 020 3003 2532 quoting location **14149** (Belmont St), max stay 2 hours
 - TAXI** Mon-Fri 6pm - 4am, Sat - Sun 10am - 4pm and 9pm - 4am
 - LBAY** No Loading Mon-Sun 12noon - 2pm and 4pm - 10am (No waiting at any time)
 - SLP2** Loading: Mon-Sun 10am - 12noon and 2pm - 4pm
Parking: Mon-Sun 8.30am - 10am, 12noon - 2pm, 4pm - 11pm pay-by-phone 020 3003 2532 quoting location **13621** (Ferdinand St), max stay 2 hours
 - SLP3** Loading: Mon-Sun 10am - 12noon and 2pm - 4pm
Parking: Mon-Sun 8.30am - 10am, 12noon - 2pm, 4pm - 11pm pay-by-phone 020 3003 2532 quoting location **13619** (Crogland Rd), max stay 2 hours
 - SLP4** Loading: Mon-Sun 10am - 12noon and 2pm - 4pm
Parking: Mon-Sun 8.30am - 10am, 12noon - 2pm, 4pm - 11pm pay-by-phone 020 3003 2532 quoting location **13617** (Chalk Farm Rd), max stay 2 hours

- T1**
- Bay markings to be removed
 - New double yellow line markings
 - New yellow line termination markings
 - New kerb blip yellow line markings
 - New single yellow line markings
 - Waiting restriction markings to be removed
 - New kerb
 - Area with changes to note

NOTES:

- ALL ITEMS SHOWN RED ARE TO BE REMOVED. GREY ARE TO BE MAINTAINED AND BLACK ARE TO BE INSTALLED AS PART OF WORK

Rev	By	Date	Amendments
A	WH	31/07/20	Text, scale and design changes
B	WH	03/12/20	Parking changes
C	WH	25/01/20	Parking changes
D	WH	13/02/21	Parking changes, fonts and lines
E	WH	27/04/21	Waiting Rest, Ferdinand-Harwood St

Rev	By	Date	Amendments

Camden
 Design Team
 Transport Strategy Service
 London Borough of Camden
 5 Pancras Square
 Tel 020 7974 5551, Fax 020 7974 6952
 DX 2106 Euston, Minicom 020 7974 6866

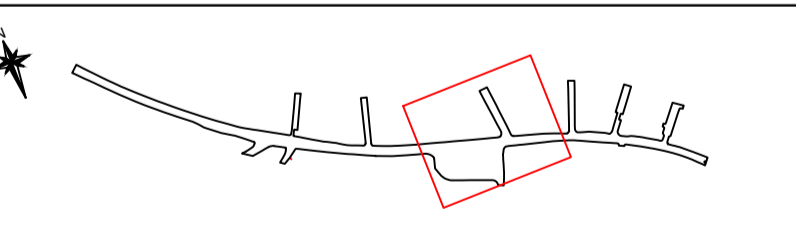

Project
**CHALK FARM ROAD / HAVERSTOCK HILL
 POP-UP CYCLE LANES
 AND JUNCTIONS IMPROVEMENTS**

Drawing Title
**REVISED PARKING SIGNAGE AND BAYS
 LAYOUT**

Scale 1 : 250 @ A1	Date JULY 2020
Drawn By WH	File Ref camden.net/Cd_Sema/219-2018/Chalk Farm CS_Developer/CD
Checked By YK	Dwg Name POP-UP CYCLE LANES
Drawing Location -	

Drawing Number
S106/037-CS-1200-01-004

Rev
E

The Camden (Chalk Farm Road and Neighbouring Streets) (Modification No. 3) Experimental Traffic Order 2021

2021 No. 57

LONDON BOROUGH OF CAMDEN

TRAFFIC MANAGEMENT ORDER

2021 No. 57

The Camden (Chalk Farm Road and Neighbouring Streets) (Modification No. 3)
Experimental Traffic Order 2021

Made on 5 July 2021

Coming into force on 15 July 2021

The Council of the London Borough of Camden, after consulting the Commissioner of Police of the Metropolis, in exercise of the powers conferred by section 9 of Road Traffic Regulation Act 1984 [1984 c. 27], and of all other powers thereunto enabling, hereby make the following order:

1. Citation and commencement

- 1.1 This order shall come into force on 15 July 2021 and may be cited as the Camden (Chalk Farm Road and Neighbouring Streets) (Modification No. 3) Experimental Traffic Order 2021.

2. Interpretation

- 2.1 Any reference in this order to any enactment shall be construed as a reference to that enactment as amended, applied, consolidated, re-enacted by or as having effect by virtue of any subsequent enactment.

3. Revocation and designation of parking places

- 3.2 The Camden (Parking Places) (CA-F) Traffic Order 2012 [L.B.C 2012 No.6] shall have effect as though;
- 3.2.1 there was omitted from schedule 2 to that order, the items set out in table 1 of the schedule to this order;
- 3.2.2 there was included in schedule 2 to that order, the items set out in table 2 of the schedule to this order;
- 3.2.3 there was omitted from schedule 3 to that order, the items set out in table 3 of the schedule to this order;
- 3.2.4 there was included in schedule 3 to that order, the items set out in table 4 of the schedule to this order.

3.3 The Camden (Loading Places) Traffic Order 2012 [L.B.C. 2012 No. 21] shall have effect as though there were omitted from schedule 1 to that order, the items set out in table 5 of the schedule to this order.

4. Power to modify or amend this order

4.1 Pursuant to Section 10 (2) of the Act of 1984, the Director of Regeneration & Planning, Supporting Communities Directorate, or any person authorised by him may, if it appears to him or such other authorised person essential in the interest of the expeditious, convenient and safe movement of traffic, or in the provision of suitable and adequate parking, or for preserving or improving the amenities of the area through which any road affected by this order runs, modify or suspend this order or any of the provisions in this order.

Dated this 5 July 2021



Peter Mardell
Head of Parking Operations

SCHEDULE

TABLE 1 - ITEMS OMITTED FROM SCHEDULE 2 TO THE CAMDEN (PARKING PLACES) (CA-F) TRAFFIC ORDER 2012

ITEM NUMBER	STREET	LENGTH OF HIGHWAY	CONTROLLED HOURS	TARIFF (NON-DIESEL ENGINED)	TARIFF (DIESEL ENGINED)	MAXIMUM STAY
13747	HAWLEY STREET	south-east side: from a point 20.7 metres south-west of the south-western kerb line of Leybourne Street, south-westwards for a distance of 16 metres	MONDAY – SUNDAY 8.30AM – 10AM NOON – 2PM 4PM – 11PM	£3.43 per hour	£4.17 per hour	2 hours

TABLE 2 - ITEMS INCLUDED IN SCHEDULE 2 TO THE CAMDEN (PARKING PLACES) (CA-F) TRAFFIC ORDER 2012

ITEM NUMBER	STREET	LENGTH OF HIGHWAY	CONTROLLED HOURS	TARIFF (NON-DIESEL ENGINED)	TARIFF (DIESEL ENGINED)	MAXIMUM STAY
13953	HAWLEY STREET	south-east side: from a point 20.7 metres south-west of the south-western kerb line of Leybourne Street, south-westwards for a distance of 16 metres	MONDAY – FRIDAY 8.30AM – 11PM SATURDAY & SUNDAY 9.30AM – 11PM	£3.43 per hour	£4.17 per hour	2 hours

TABLE 3 - ITEMS OMITTED FROM SCHEDULE 3 TO THE CAMDEN (PARKING PLACES) (CA-F) TRAFFIC ORDER 2012

ITEM NUMBER	STREET	LENGTH OF HIGHWAY	CONTROLLED HOURS	TARIFF (NON-DIESEL ENGINED)	TARIFF (DIESEL ENGINED)	MAXIMUM STAY
13755	FERDINAND STREET	east side: from a point 2 metres north of the northern flank wall of no. 10 Ferdinand Street, northwards for a distance of 49 metres	MONDAY – FRIDAY 8.30AM – 11PM SATURDAY & SUNDAY 9.30AM – 11PM	£3.43 per hour	£4.17 per hour	2 hours

TABLE 4 - ITEMS INCLUDED IN SCHEDULE 3 TO THE CAMDEN (PARKING PLACES) (CA-F) TRAFFIC ORDER 2012

ITEM NUMBER	STREET	LENGTH OF HIGHWAY	CONTROLLED HOURS	TARIFF (NON-DIESEL ENGINED)	TARIFF (DIESEL ENGINED)	MAXIMUM STAY
13952	FERDINAND STREET	east side: from a point 26.4 metres north of the southern flank wall of no. 10 Ferdinand Street, northwards for a distance of 24.5 metres	MONDAY – FRIDAY 8.30AM – 11PM SATURDAY & SUNDAY 9.30AM – 11PM	£3.43 per hour	£4.17 per hour	2 hours

TABLE 5 – ITEMS OMITTED FROM THE SCHEDULE TO THE CAMDEN (LOADING PLACES) TRAFFIC ORDER 2012

ITEM NUMBER	STREET	LENGTH OF HIGHWAY	CONTROLLED HOURS
13747	HAWLEY STREET	south-east side: from a point 20.7 metres south-west of the south-western kerb line of Leybourne Street, south-westwards for a distance of 16 metres	MONDAY – SUNDAY 10AM – NOON 2PM – 4PM