

The Camden (Waiting and Loading Restrictions) (Civil Enforcement Area) (Amendment No. 116) Traffic Order 2020

The Camden (Parking Places) (CA-E) (Amendment No. 10) Traffic Order 2020

The Camden (Loading Places) (Amendment No. 30) Traffic Order 2020

The Camden (Prescribed Routes) (No. 7) Traffic Order 2020

Notice is hereby given that the Council of the London Borough of Camden proposes to make the above orders under Sections 6, 45, 46, 49 and 124 and Part IV of Schedule 9 to the Road Traffic Regulation Act 1984, as amended. The general nature and effect of the orders are set out below:

HUNTLEY STREET (between the junctions with Grafton Way and University Street)

Vehicular traffic to proceed in one direction, from north to south, in this section of Huntley Street.

Revocation of all parking places in this section of the street (2 "paid-for" parking places of 31 and 23 metres length, 1 loading bay of 15 metres length).

Designation of two loading bays of 10 metres length, one the north-east side approximately 30 metres north-west of the junction with University Street, the other on the south-west side approximately 5 metres north-west of the same junction

Designation of a 24-hour waiting prohibition in this section of Huntley Street (other than where loading bays are designated)

Designation of an additional 24-hour loading prohibition from the junction with Grafton Way southwards for a distance of approximately 35 metres.

UNIVERSITY STREET

Removal of a 5 metre section of the paid-for parking place on the south-east side, immediately north-east of the junction with Huntley Street. Designation of a 24-hour prohibition on waiting on the south-east side from the junction with Huntley Street for a distance of approximately 12.5 metres

Copies of the proposed order and the Council's Statement of Reasons for proposing to make the order may be inspected at camden.gov.uk/recently-advertised-proposals or at the council's offices at 5 Pancras Square, N1C 4AG. Any person wishing to object or make representations in respect of the proposed order should send comments in writing, giving reasons for any objection to agnieszka.jezierska@camden.gov.uk or by post to FREEPOST LBC TRANSPORT STRATEGY, to be received by the end of 17 December 2020.

Notice is also given under s.90C of the Highways Act 1980 of the council's intention to construct a flat-top table junction at the junction of Huntley Street with Grafton Way, extending approximately 35 metres south-eastwards into Huntley Street, constructed to a maximum height of 100mm. Comments on this proposal can be sent to the same addresses above.

Peter Mardell - Head of Parking Operations
26 November 2020

The Camden (Waiting and Loading Restrictions) (Civil Enforcement Area) (Amendment No. 116) Traffic Order 2020
The Camden (Parking Places) (CA-E) (Amendment No. 10) Traffic Order 2020
The Camden (Loading Places) (Amendment No. 30) Traffic Order 2020
The Camden (Prescribed Routes) (No. 7) Traffic Order 2020

STATEMENT OF REASONS

These works are to help facilitate the implementation of a mini-pocket park in the upper section of Huntley Street as well as changes in direction of travel on Huntley Street. They are part of the West End Project - a £35 million public realm project bringing exciting improvements to the heart of Camden's busy West End.

The project will deliver a bold vision for the future of the area which currently suffers from traffic congestion, road safety issues, narrow pavements, poor air quality and a lack of public spaces.

PROPOSED LAYOUT PLAN

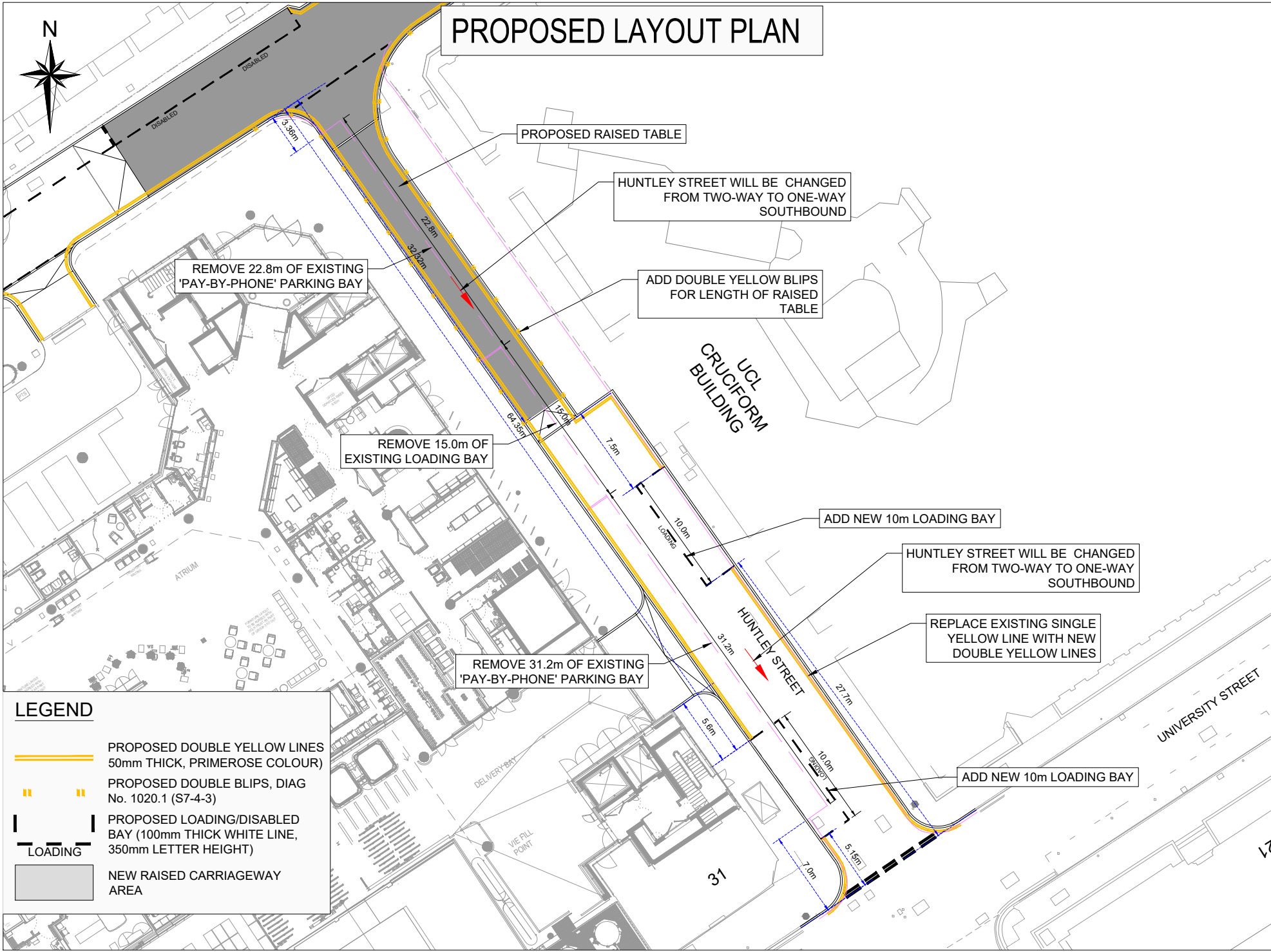

REMOVE 22.8m OF EXISTING 'PAY-BY-PHONE' PARKING BAY

PROPOSED RAISED TABLE

HUNTLEY STREET WILL BE CHANGED FROM TWO-WAY TO ONE-WAY SOUTHBOUND

ADD DOUBLE YELLOW BLIPS FOR LENGTH OF RAISED TABLE

REMOVE 15.0m OF EXISTING LOADING BAY

ADD NEW 10m LOADING BAY





HUNTLEY STREET WILL BE CHANGED FROM TWO-WAY TO ONE-WAY SOUTHBOUND

REMOVE 31.2m OF EXISTING 'PAY-BY-PHONE' PARKING BAY

REPLACE EXISTING SINGLE YELLOW LINE WITH NEW DOUBLE YELLOW LINES

ADD NEW 10m LOADING BAY

LEGEND

-  PROPOSED DOUBLE YELLOW LINES 50mm THICK, PRIMEROSE COLOUR)
-  PROPOSED DOUBLE BLIPS, DIAG No. 1020.1 (S7-4-3)
-  PROPOSED LOADING/DISABLED BAY (100mm THICK WHITE LINE, 350mm LETTER HEIGHT)
-  NEW RAISED CARRIAGEWAY AREA

The Camden (Waiting and Loading Restrictions) (Civil Enforcement Area) (Amendment No. 116) Traffic Order 2020

2020 No. 94

**HUNTLEY STREET
UNIVERSITY STREET**

LONDON BOROUGH OF CAMDEN

TRAFFIC MANAGEMENT ORDER

2020 No. 94

The Camden (Waiting and Loading Restrictions) (Civil Enforcement Area)
(Amendment No. 116) Traffic Order 2020

Made on

Coming into force on

The Council of the London Borough of Camden, after consulting the Commissioner of Police of the Metropolis, in exercise of the powers conferred by sections 6 and 124 of and part IV of schedule 9 to the Road Traffic Regulation Act 1984 [1984 c. 27], as amended by section 8 of and part I of schedule 5 to the Local Government Act 1985 [1985 c. 51], and of all other powers thereunto enabling, hereby make the following order:

1. Citation and commencement

- 1.1 This order shall come into force on _____ and may be cited as the Camden (Waiting and Loading Restrictions) (Civil Enforcement Area) (Amendment No. 116) Traffic Order 2020.

2. Interpretation

- 2.1 In this order;
- 2.1.1 the term "parent order" means the Camden (Waiting and Loading Restrictions) (Civil Enforcement Area) Traffic Order 2012 [L.B.C 2012 No. 1];
- 2.1.2 any reference in this order to any enactment shall be construed as a reference to that enactment as amended, applied, consolidated, re-enacted by or as having effect by virtue of any subsequent enactment;
- 2.1.3 unless the context otherwise requires, any expression used in this order which is also used in the parent order shall have the same meaning as in that order.

3. Amendment to schedules 1 and 2 to the parent order

- 3.1 Without prejudice to the validity of anything done or to any liability incurred in respect of any act or omission before the coming into force of this order the parent order shall have effect as though there was substituted for the items set out in relation to the similarly named streets in schedule 1 to the parent order, the items set out in the table of the schedule to this order;

Dated this

SCHEDULE

TABLE 1 - ITEMS SUBSTITUTED IN RESPECT OF THE SIMILARLY NAMED STREET IN SCHEDULE 1 TO THE PARENT ORDER

ITEM NUMBER	STREET – SIDE OF STREET – LENGTH OF HIGHWAY	RESTRICTED HOURS See Schedule
494	HUNTLEY STREET	
(a)	north-east side:	
(ii)	from the south-eastern kerb line of Torrington Place, south-eastwards for a distance of 10 metres	A
(b)	south-west side: from the south-eastern kerb line of Torrington Place to a point 10.5 metres south-east of the south-eastern kerb line of Torrington Place	A
(c)	both sides: between the south-eastern kerb line of Grafton Way and the north-western kerb line of University Street	A
(i)	between the south-eastern kerb line of Grafton Way and the north-western kerb line of University Street	A
(ii)	so much else of Huntley Street that is public highway and which does not lie within those lengths specified above	F
954	UNIVERSITY STREET	
(a)	north-west side:	
(i)	from a point 6.0 metres west of the western flank wall of the Public House, no.31 University Street, westwards for a distance of 10.5 metres	A
(ii)	from the north-eastern kerb line of Tottenham Court Road, north-eastwards for a distance of 20 metres	A

(b)	south-east side:	
(i)	from the north-eastern kerb line of Tottenham Court Road, north-eastwards for a distance of 10 metres	A
(ii)	from the north-eastern kerb line of Huntley Street, north-eastwards for a distance of 12.5 metres	A
(c)	both sides:	
(i)	from the south-western kerb line of Gower Street, south-westwards for a distance of 10 metres	A
(ii)	so much else of University Street that is public highway and which does not fall within those lengths specified above	F

TABLE 2 – ITEMS INCLUDED IN, OR SUBSTITUTED FOR SIMILARLY NAMED STREETS, IN SCHEDULE 2 TO THE PARENT ORDER

ITEM NUMBER	STREET – SIDE OF STREET – LENGTH OF HIGHWAY	RESTRICTED HOURS See Schedule
	HUNTLEY STREET	
(a)	from the south-eastern kerb line of Grafton Way, south-eastwards for a distance of 32.5 metres	1
	UNIVERSITY STREET	
(a)	north-west side: from the north-eastern kerb line of Tottenham Court Road, north-eastwards for a distance of 10 metres	1
(b)	south-east side: from the north-eastern kerb line of Huntley Street, north-eastwards for a distance of 12.5 metres	1

**The Camden (Parking Places) (CA-E) (Amendment No. 10)
Traffic Order 2020**

2019 No. 95

**HUNTLEY STREET
UNIVERSITY STREET**

LONDON BOROUGH OF CAMDEN

TRAFFIC MANAGEMENT ORDER

2020 No. 95

The Camden (Parking Places) (CA-E) (Amendment No. 10) Traffic Order 2020

Made on

Coming into force on

The Council of the London Borough of Camden, after consulting the Commissioner of Police of the Metropolis, in exercise of the powers conferred by sections 45, 46, 49 and 124 of and part IV of schedule 9 to the Road Traffic Regulation Act 1984 [1984 c. 27], as amended by section 8 of and part I of schedule 5 to the Local Government Act 1985 [1985 c. 51], and of all other powers thereunto enabling, hereby make the following order:

1. Citation and commencement

1.1 This Order shall come into force on _____ and may be cited as The Camden (Parking Places) (CA-E) (Amendment No. 10) Traffic Order 2020.

2. Interpretation

2.1 In this order:

2.1.1 the term "parent order" means the Camden (Parking Places) (CA-E) (Traffic Order 2012 [L.B.C 2012 No. 5];

2.1.2 any reference in this order to any other order or enactment shall be construed as a reference to that order or enactment as amended, applied, consolidated, re-enacted by or as having effect by virtue of any subsequent order or enactment;

2.1.3 unless the context otherwise requires, any expression used in this order which is also used in the parent order shall have the same meaning as in that order.

3. Revocation and designation of parking places

3.1 Without prejudice to the validity of anything done or to any liability incurred in respect of any act or omission before the coming into force of this order the parent order shall have effect as though:

3.1.1 there was omitted from schedule 2 to the parent order, the item set out in table 1 of the schedule to this order;

3.1.2 there was included in schedule 2 to the parent order, the items set out in table 2 of the schedule to this order.

Dated this

SCHEDULE

TABLE 1 – ITEMS OMITTED FROM SCHEDULE 2 TO THE PARENT ORDER

ITEM NUMBER	STREET	LENGTH OF HIGHWAY	CONTROLLED HOURS	TARIFF (NON-DIESEL ENGINED)	TARIFF (DIESEL ENGINED)	MAXIMUM STAY
2255	HUNTLEY STREET	the south-west side, from a point 3.3 metres south-east of the south-eastern kerb-line of Grafton Way, south-eastwards for a distance of 22.7 metres.	MONDAY – SATURDAY 8.30AM – 6.30PM	£5.92 per hour	£7.20 per hour	2 hours
2256	HUNTLEY STREET	the south-west side, from a point 7.5 metres north-west of the north-western kerb-line of University Street, north-westwards for a distance of 29.7 metres.	MONDAY – SATURDAY 8.30AM – 6.30PM	£5.92 per hour	£7.20 per hour	2 hours
13308	UNIVERSITY STREET	south-east side: from a point 7 metres north-east of the north-eastern kerb line of Huntley Street, north-eastwards for a distance of 38.3 metres	MONDAY – SATURDAY 8.30AM – 6.30PM	£5.92 per hour	£7.20 per hour	2 hours

TABLE 2 – ITEMS INCLUDED IN SCHEDULE 2 TO THE PARENT ORDER

ITEM NUMBER	STREET	LENGTH OF HIGHWAY	CONTROLLED HOURS	TARIFF (NON-DIESEL ENGINED)	TARIFF (DIESEL ENGINED)	MAXIMUM STAY
13734	UNIVERSITY STREET	south-east side: from a point 12.5 metres north-east of the north-eastern kerb line of Huntley Street, north-eastwards for a distance of 33 metres	MONDAY – SATURDAY 8.30AM – 6.30PM	£5.92 per hour	£7.20 per hour	2 hours

**The Camden (Loading Places) (Amendment No. 30)
Traffic Order 2020**

2020 No. 96

HUNTLEY STREET

LONDON BOROUGH OF CAMDEN

TRAFFIC MANAGEMENT ORDER

2020 No. 96

The Camden (Loading Places) (Amendment No. 30) Traffic Order 2020

Made on

Coming into force on

The Council of the London Borough of Camden, after consulting the Commissioner of Police of the Metropolis, in exercise of the powers conferred by sections 6 and 124 of and part IV of schedule 9 to the Road Traffic Regulation Act 1984 [1984 c. 27], as amended by section 8 of and part I of schedule 5 to the Local Government Act 1985 [1985 c. 51], and of all other powers thereunto enabling, hereby make the following order:

1. Citation and commencement

1.1 This order shall come into force on _____ and may be cited as the Camden (Loading Places) (Amendment No. 30) Traffic Order 2020.

2. Interpretation

2.1 In this order:

2.1.1 the term "parent order" means the Camden (Loading Places) (Traffic Order 2012 [L.B.C 2012 No. 21];

2.1.2 any reference in this order to any enactment shall be construed as a reference to that enactment as amended, applied, consolidated, re-enacted by or as having effect by virtue of any subsequent enactment;

2.1.3 unless the context otherwise requires, any expression used in this order which is also used in the parent order shall have the same meaning as in that order.

3. Amendments to the schedule to the parent order

3.1 Without prejudice to the validity of anything done or to any liability incurred in respect of any act or omission before the coming into force of this order the parent order shall have effect as though;

3.1.1 there was omitted from schedule 1 to the parent order the item set out in table 1 in the schedule to this order;

3.1.2 there was included in schedule 1 to the parent order, the items set out in table 2 of the schedule to this order.

Dated this

SCHEDULE

TABLE 1 - ITEMS OMITTED FROM SCHEDULE 1 TO THE PARENT ORDER

ITEM NUMBER	STREET	LENGTH OF HIGHWAY	CONTROLLED HOURS
9977	HUNTLEY STREET	south-west side from a point 26.2 metres south-east of the south-east kerb line of Grafton Way, south-eastward for a distance of 15.70 metres.	MONDAY - SATURDAY 8.30AM - 6.30PM

TABLE 2 – ITEMS INCLUDED IN SCHEDULE 1 TO THE PARENT ORDER

ITEM NUMBER	STREET	LENGTH OF HIGHWAY	CONTROLLED HOURS
13732	HUNTLEY STREET	north-east side: from a point 27.7 metres north-west of the north-western kerb line of University Street, north-westwards for a distance of 10 metres	AT ANY TIME
13733	HUNTLEY STREET	south-west side: from a point 5.2 metres north-west of the north-western kerb line of University Street, north-westwards for a distance of 10 metres	AT ANY TIME

The Camden (Prescribed Routes) (No. 7) Traffic Order 2020

2020 No. 97

HUNTLEY STREET

LONDON BOROUGH OF CAMDEN

TRAFFIC MANAGEMENT ORDER

2020 No. 97

The Camden (Prescribed Routes) (No. 7) Traffic Order 2020

Made on

Coming into force on

The Council of the London Borough of Camden, after consulting the Commissioner of Police of the Metropolis, in exercise of the powers conferred by sections 6 and 124 of and part IV of schedule 9 to the Road Traffic Regulation Act 1984 [1984 c. 27], as amended by section 8 of and part I of schedule 5 to the Local Government Act 1985 [1985 c. 51], and of all other powers thereunto enabling, hereby make the following order:

1. Citation and commencement

- 1.1 This order shall come into force on _____ and may be cited as the Camden (Prescribed Routes) (No. 7) Traffic Order 2020.

2. Interpretation

- 2.1 Any reference in this order to any enactment shall be construed as a reference to that enactment as amended, applied, consolidated, re-enacted by or as having effect by virtue of any subsequent enactment.

3. Restrictions

- 3.1 No person shall cause any vehicle to proceed in the section of Huntley Street which lies between its junctions with Grafton Way and University Street in any direction other than from north-west to south-east.

5. Exemptions

- 5.1 Nothing in Article 4 shall apply in respect of;
- 5.1.1 a pedal cycle;
- 5.1.2 anything done with the permission of a police constable or traffic warden in uniform;
- 5.1.3 any person causing any vehicle to proceed in accordance with any restriction or requirement indicated by traffic signs placed pursuant to Section 66 or 67 of the Road Traffic Regulation Act 1984.

Dated this

